

MEMORANDUM

To: Kathleen Smith, City of Haverhill

From:  William G. Cunniff - Joslin, Lesser + Associates, Inc.

Date: March 22, 2016

Re: Construction Contingency Approval: Caleb Dustin Hunking School

Cc: James F. Scully; Jeffery Luxenberg; Adam Sniegocki

Enclosed for approval and processing, please find the following commitments:

1) GMP Contingency Approval Request: Budget Transfer No. Change Request No. 179 (BT-179): This request to use GMP Contingency funds is the result of PR-012 issued by the designer, JCJ. This PR details the addition of motors to 5 doors and power to 1 door.

Clarify overhead and sectional doors and fire ratings - Description of Work	Value \$
This PR was issued to provide details on the type and power requirements for coiling overhead doors in the main hallway. The cost is to provide power to one (1) door location, which is not identified on the construction documents. The funds for this work will be allocated from the GMP Contingency budget line item.	\$ 2,251.00
	\$ 2,251.00

2) GMP Contingency Approval Request: Budget Transfer No. Change Request No. 180 (BT-180): This request to use GMP Contingency funds is the result of CCD-009 issued by the designer, JCJ. These CCD details revisions made to the hollow metal door frame dimensions.

HM door frame changes per CCD-009 - Description of Work	Value \$
CCD-009 was issued to provide revisions to the door schedule, clarifying dimensional changes, which required both the replacement of HM frames and also the addition of larger glass panels. The funds for this work will be allocated from the GMP Contingency budget line item.	\$ 29,529.00
	\$ 29,529.00

3) Construction Contingency Approval Request: Change Request No. 031 (CR-031): This request to use Construction Contingency funds is the result of RFI-059R1 issued by the designer, JCJ. The funds for this work will be re-allocated from the Construction Contingency budget line item, to the Construction Change Order line item as a lump sum proposal. A Budget Revision Request will follow.

Revise dimensions of chiller support per RFI-059R1 - Description of Work	Value \$
Similar to the previously approved structural steel modifications to HVAC RTU's, and in order to maintain overall project schedule, this change incorporated minor steel beam modifications to the supporting steel for the roof top chiller equipment, based upon dimensions and location, that were finalized only after release of the main structural steel package.	\$ 4,906.00
	\$ 4,906.00

4) Construction Contingency Approval Request: Change Request No. 064 (CR-064): This request to use Construction Contingency funds is the result of CCD-008R1 issued by the designer, JCJ. The funds for this work will be re-allocated from the Construction Contingency budget line item, to the Construction Change Order line item as a lump sum proposal. A Budget Revision Request will follow.

Add backflow preventer at water meter per CCD-08R1 - Description of Work	Value \$
At the request of the Haverhill Water Department, this CCD was issued to provide a backflow preventer and all necessary modifications to the water main connection.	\$ 13,353.00
	\$ 13,353.00

5) Construction Contingency Approval Request: Change Request No. 078 (CR-078): This request to use Construction Contingency funds is the result of CCD-013 issued by the designer, JCJ. The funds for this work will be re-allocated from the Construction Contingency budget line item, to the Construction Change Order line item as a lump sum proposal. A Budget Revision Request will follow.

Add structural steel beam to support sliding glass partition per CCD-013 - Description of Work	Value \$
This RFI was issued to provide details to modify the supporting steel for the sliding glass partition located at the Media Center. The details of this partition could be finalized only upon the submission of the sliding glass partition system.	\$ 1,551.00
	\$ 1,551.00

6) Construction Contingency Approval Request: Change Request No. 080 (CR-080): This request to use Construction Contingency funds is the result of CCD-012 issued by the designer, JCJ. The funds for this work will be re-allocated from the Construction Contingency budget line item, to the Construction Change Order line item as a lump sum proposal. A Budget Revision Request will follow.

Add floor box at Project Area A315 per CCD-012 - Description of Work	Value \$
This change order request is to add an additional floor outlet to a project area per the school department. Based upon final furniture locations, it was determined that it was necessary to add this floor outlet, which is not shown on the construction documents.	\$ 2,634.00
	\$ 2,634.00

7) Construction Contingency Approval Request: Change Request No. 083 (CR-083): This request to use Construction Contingency funds is the result of RFI-292 issued by the designer, JCJ. The funds for this work will be re-allocated from the Construction Contingency budget line item, to the Construction Change Order line item as a lump sum proposal. A Budget Revision Request will follow.

Add soffit in Art Room A227 to conceal deep beam & gas line per RFI-292 - Description of Work	Value \$
This change order request is to create a gypsum wallboard soffit to enclose both a deep steel beam and also several mechanical components relocated during MEP coordination.	\$ 2,700.00
	\$ 2,700.00

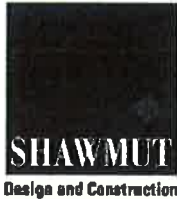

Change Request BT179

To: William Cunniff
Joslin Lesser & Assoc
44 Pleasant Street
Watertown, MA 02472

Date: March 5, 2016
Project #: 131411
Project: MSBA - Haverhill Caleb Dustin MS

Description: Clarify Overhead and Sectional doors, and fireratings. Add motors to 5 doors and power to 1. ref ASI 012; PR 012

Item Description	Amount
LeVangie; Add power to 1 door.	\$(2,251)
LeVangie; Add power to 1 door.	\$2,251
Total:	\$0

Type: Lump sum proposal
Schedule Impact: This change will add 0 day(s) to the contract completion date.
Overtime: Project OT Not Required

Notes:
Please note that Baron (the Overhead door supplier) has indicated that it is a wash to switch door types and add the motors. This pricing is for adding power at 1 door.

By: William Cunniff, Joslin Lesser & Assoc

3/16/16
Date:

By: Joseph Pollock, Shawmut Design & Construction

3/11/16
Date:

By: Katy Lillich, JCJ Architecture, Inc.

3.15.16
Date:

Pollock, Joseph T

CR29

From: sales@baronind.com
Sent: Friday, February 19, 2016 10:52 AM
To: Pollock, Joseph T
Subject: Baron Checking In

Baron Associates

Follow Up Flag: Follow up
Flag Status: Completed

Joseph,

Just checking in. By the way, the change of the manual chain hoist fire doors to the motorized fully glazed sectional doors and addition of two more motors at the dock doors are a push. The material cost is a little less but the freight and install of five additional motors "easily" off set that. When are you going to need the goods?

Hope All is Well,

John (Buddy)

CR29

LEVANGIE ELECTRIC CO. INC.

59 OLD WEBSTER ST.
HANOVER, MA. 02339
Phone 781 792-4900 ext 311
Fax 781 871-2891

March 7, 2016

SHAWMUT DESIGN & CONSTRUCTION
560 HARRISON AVE.
BOSTON, MA. 02118
ATTN: ROBERT JOUBERT

RE: CALEB DUSTIN HUNKING SCHOOL
SUBJECT: PR #12

Dear Robert,

As per your request, we herewith submit our quote in the amount listed below for electric changes detailed in the above referenced PR 12. Please refer to the breakdown listed below.

MATERIALS					\$	318.10
					\$	-
BASE RATE	\$	47.08 /HR	X	19.33 /HR	\$	910.06
HEALTH & PENSION	\$	28.46 /HR	X	19.33 /HR	\$	550.13
SUBTOTAL					\$	1,778.29
OVERHEAD/ PROFIT		10%			\$	177.83
LABOR BURDEN		30%			\$	273.02
SUBTOTAL					\$	2,229.13
BOND PREMIUM		1.00%			\$	22.29
TOTAL THIS CHANGE					\$	2,251.00

Please issue a written change order if we are to proceed with this change.

Sincerely,



John P. O'Neil

Lower-tier Subs. Use SUB-
SUBCONTRACTOR Form. NOT this form

Caleb Dustin Banking School	PROJECT NUMBER:	PROJ. NO.	Shawmut Design & Construction C.M.
	DATE:	PERIOD	
FIRM SUBMITTING CHANGE REQUEST:			
LeVangie Electric Co., Inc.			

DIRECT LABOR; SUBCONTRACTOR and/or SUBSUBCONTRACTOR.

[illegible]

Grade	Classification (Personnel Bureau or in Apprentices)	Total Hrs. Worked	These values shall be taken from the "REQUIRED FOR APPROVAL FOR CHANGE ORDER PRIOR INC." form, after its approval by the CMAA and Owner					Total Direct Labor Cost
			Total Hourly Labor Costs Item E from Wage Approval Sheet	Total Base Cost + Fringe	Base Wages Item B from Wage Approval Sheet	Total Direct Labor Cost		
C-1	FOREMAN/BUILD	19.87	\$ 47.08	\$ 910.16	\$ 28.46	\$ 910.16	\$	
				\$			\$	
				\$			\$	
				\$			\$	
				\$			\$	
				Total Base Wages:	\$ 581.3	\$	\$ 910.16	
				TOTAL BASE and FRINGE DIRECT LABOR COSTS			\$ 1,360.19	

2. MAIN RESULTS: SUBCONTRACT FOR:

the \mathcal{H}^1 -norm, and the \mathcal{H}^1 -norm of the difference between the exact solution and the numerical solution is bounded by $C\tau^{\frac{1}{2}}$. The error estimate is sharp, since the error is of order $\tau^{\frac{1}{2}}$ for the \mathcal{H}^1 -norm.

	Material Description	Crate	Unit	Cost Per Unit	Total
MATERIALS		1100		\$2.810	\$
					\$
					\$
					\$
					\$
					\$
					\$
	TOTAL MATERIALS COST:				\$ 348.10

HÖLDER'S SUBCONTRACTOR

for extensive comparison to the results obtained for the two-body problem.

Equipment Description	Qty	Unit	Cost Per Unit	Total
			\$	\$
			\$	\$
			\$	\$
			\$	\$
TOTAL EQUIPMENT COST:			\$	\$

SUBMITTER
DATE:

3.4.2016

PCIDENCE PROJECT

CHANGE REQUEST

LeVangie Electric Co. Inc.

4. LUMP SUM SERVICES PROVIDED TO SUBCONTRACTOR (Not Typical Contract for Directwork)

Description of Lump Sum Services (attach backup)	Total
	\$
	\$
	\$
	\$
TOTAL LUMP SUM SERVICES COST:	\$

5. SUBTOTAL OF SUBCONTRACTOR'S DIRECT COSTS (ITEMS 1, 2, 3, and 4)

\$ 1,779.39

6. SUBCONTRACTOR'S ALLOWED & P MARK-UP ON ALLOWABLE DIRECT COSTS (10% OF ITEM 5)

\$ 177.94

7. INSURANCE AND TAXES ON SUBCONTRACTOR BASE LABOR ONLY:

9.10 (10%)
30.00%

TOTAL COST INSURANCE AND TAXES ON LABOR

\$ 211.93

8. TOTAL COST OF WORK PERFORMED BY SUBCONTRACTOR (ITEMS 5, 6, and 7):

\$ 2,229.13

9. TOTAL COST OF WORK PERFORMED BY SUBS (ON LUMP SUM) (Item 7 on attached Sub-Sub Form):

\$

10. ALLOWABLE MARKUP ON SUB-SUBCONTRACTOR'S WORK (By Contract, 10% of Item 5 on attached Sub-Sub Form):

\$

11. TOTAL COST OF WORK INCLUDED IN THIS CHANGE REQUEST (ITEMS 9, 10):

\$ 2,229.13

12. SUBCONTRACTOR BOND

Amount bond required (see item 11)

\$ 2,229.13

13. TOTAL CHANGE PROPOSAL AMOUNT, including bond cost

\$ 2,251.00

Additional Notes:

Change proposals must include a cover letter on company letterhead identifying the PFI number, a description of the scope of work and the total cost of the Change Request.

** By Contract, the maximum aggregate mark-up allowed on direct allowable costs is 10%, and may be shared between Sub and Sub-Subs, where applicable.

Job Name: Caleb Dustin Hunking School

Column 1	Column 2	Column 3	Column 4	Column 5
PR#12	base bid	base bid	Combined	ALL

Items+ByProducts

Item #	Item Name	QUANTITY	Mtl Price	MAT. EXT.	Labor	LABOR EXT.
Category: Cost Code BRANCH RACEWAY						
830	EMT 3/4	80.00	\$0.59 E	\$47.50	0.070 E	5.60
892	EMT 3/4 STL SET SCRE	9.60	\$0.27	\$2.62	0.042	0.40
914	EMT 3/4 STL SET SCRE	4.00	\$0.22	\$0.89	0.042	0.17
946	EMT 1/2 ONE HOLE ST	1.00	\$0.23	\$0.23	0.056	0.06
947	EMT 3/4 ONE HOLE ST	9.60	\$0.30	\$2.91	0.028	0.27
966	CONDUIT 3/8 FLEX STE	3.00	\$0.42	\$1.26	0.042	0.13
978	RACO 3301 3/8 INS SQ	2.00	\$3.94	\$7.89	0.126	0.25
1,444	4 SQ W-1/2 KO	1.00	\$6.09	\$6.09	0.280	0.28
1,445	4 SQ DEEP W-1/2+3/4 K	3.00	\$4.58	\$13.73	0.210	0.63
1,482	BELL 251 1G WP BOX	1.00	\$3.25	\$3.25	0.560	0.56
1,515	4 SQ TOGG. MULB CO	1.00	\$1.87	\$1.87	0.098	0.10
Totals for Cost Cod				\$88.23		8.44
Category: Cost Code SITE						
5,337	DRY CORE 1-.2"	2.00	\$7.80 E	\$15.60	0.490	0.98
Totals for Cost Cod				\$15.60		0.98
Category: Cost Code HARDWARE						
2,707	RAWL 7525 14X1 PLST	9.60	\$0.05	\$0.50	0.024	0.23
2,724	SCREWS 10X3/4 PAN H	11.60	\$5.69	\$65.96	0.014	0.16
2,725	SCREWS 10X1 PAN HD	2.00	\$6.01	\$12.03	0.028	0.06
Totals for Cost Cod				\$78.49		0.45
Category: Cost Code GEAR, PANELS & DISC.SWs						
2,342	GE THQ82120 2P20A 1	1.00	\$78.19 E	\$78.19	0.280	0.28
Totals for Cost Cod				\$78.19		0.28
Category: Cost Code DEVICES & PLATES						
1,731	S1 KEY 4801-L	1.00	\$6.29 E	\$6.29	0.350	0.35
1,733	LEV 1121 SP 20A 277V	0.00	\$2.74	\$0.00	0.250	0.00
1,734	LEV 1122 DP 20A 277V	1.00	\$2.32	\$2.32	0.280	0.28
2,972	BELL 223V 1G WP DPL	1.00	\$2.64	\$2.64	0.098	0.10
Totals for Cost Cod				\$11.25		0.73
Category: Cost Code WIRE						
56	THHN-12-BLACK-STRA	260.00	\$0.12	\$30.95	0.005	1.43
294	12/2 MC CABLE W/G	25.00	\$0.60	\$15.01	0.013	0.31
2,514	#14 CONTROL TERM	4.00	\$0.00	\$0.00	0.224	0.90
2,518	20A WIRE TERMINATI	3.00	\$0.00	\$0.00	0.168	0.50
2,680	IDEAL 30 074 SIZE 748	5.00	\$0.08	\$0.39	0.001	0.01

Job Name: Caleb Dustin Hunking School

Totals for Cost Cod

\$46.35

3.15

Category: Cost Code MISC.

6,840 CLEAN UP HOUR	0.50	\$0.00	\$0.00	1.000	0.50
6,845 ONSITE TRADE COOR	1.00	\$0.00	\$0.00	1.000	1.00
6,850 SITE SUPERVISION	2.00	\$0.00	\$0.00	1.000	2.00
60,011 LIMIT SWITCH FBO	2.00	\$0.00	\$0.00	0.600	1.20
60,013 PUSHBUTTON FBO	1.00	\$0.00	\$0.00	0.600	0.60

Totals for Cost Cod

\$0.00

5.30

Totals:

\$318.10

19.33

Report Totals:

Items+ByProducts

MAT. EXT.	LABOR EXT.
\$318.10	19.33



AIA® Document G710™ – 1992

Architect's Supplemental Instructions

PROJECT (Name and address):

Caleb Dustin Hunking School
98 Winchester St.
Haverhill MA 01835

ARCHITECT'S SUPPLEMENTAL

INSTRUCTION NO: 012

OWNER: ☐

ARCHITECT: ☐

CONSULTANT: ☐

CONTRACTOR: ☐

FIELD: ☐

OTHER: ☒

OWNER (Name and address):

City of Haverhill
4 Summer Street, Room 100
Haverhill, MA 01830

DATE OF ISSUANCE: 10/16/2015

CONTRACT FOR: General Construction

FROM ARCHITECT (Name and address):

JCJ Architecture
One State Street, Suite 900
Boston, MA 02109

CONTRACT DATE: May 14, 2013

TO CONTRACTOR (Name and address):

Shawmut Design & Construction
560 Harrison Ave
Boston MA 02118

ARCHITECT'S PROJECT NUMBER:

B130200.00

The Work shall be carried out in accordance with the following supplemental instructions issued in accordance with the Contract Documents without change in Contract Sum or Contract Time. Proceeding with the Work in accordance with these instructions indicates your acknowledgment that there will be no change in the Contract Sum or Contract Time.

DESCRIPTION:

With reference to Drawing Sheet G-003, this ASI shall clarify that the demising wall between the Gymnasium and main corridor, along the "K" structural grid line between grid lines "10" and "19" is not required to be a rated wall. As a consequence, revisions to add a fire rated overhead roll-down door system as described within SK-002, SK-003 and SK-004 included within Addendum 5 shall be voided. Glass Overhead Sectionals Doors (total of 3) along the "K" grid line shall remain.

ATTACHMENTS:

(Here insert listing of documents that support description.)

None

ISSUED BY THE ARCHITECT:

(Signature)

Katy Lillich

(Printed name and title)



AIA[®] Document G709[™] – 2001

Work Changes Proposal Request

PROJECT *(Name and address):*
Calcb Dustin Hunking School
98 Winchester Street
Haverhill, MA 01835

PROPOSAL REQUEST NUMBER: 012

DATE OF ISSUANCE: 11/09/2015

OWNER: ☐

ARCHITECT: ☐

CONSULTANT: ☐

CONTRACTOR: ☐

FIELD: ☐

OTHER: ☐

OWNER *(Name and address):*
City of Haverhill
Four Summer Street, Room 100
Haverhill, MA 01830

CONTRACT FOR: General Construction

CONTRACT DATE: May 14, 2013

FROM ARCHITECT *(Name and address):*
JCJ Architecture
One State Street, Suite 900
Boston, MA 02109

ARCHITECT'S PROJECT NUMBER:
R130200.00

TO CONTRACTOR *(Name and address):*
Shawmut Design & Construction
560 Harrison Avenue
Boston, MA 02118

Please submit an itemized proposal for changes in the Contract Sum and Contract Time for proposed modifications to the Contract Documents described herein. Within Zero (0) days, the Contractor must submit this proposal or notify the Architect, in writing, of the date on which proposal submission is anticipated.

THIS IS NOT A CHANGE ORDER, A CONSTRUCTION CHANGE DIRECTIVE OR A DIRECTION TO PROCEED WITH THE WORK DESCRIBED IN THE PROPOSED MODIFICATIONS.

DESCRIPTION *(Insert a written description of the Work):*

Add door power to overhead door A125 per attached sketch SK-07.

ATTACHMENTS *(List attached documents that support description):*

SKE-07

REQUESTED BY THE ARCHITECT:

(Signature)

Katy Lillich
(Printed name and title)

— LIMIT SWITCH FURNISHED BY OTHERS.
— INSTALLED BY E.C. - COORDINATE EXACT
LOCATION WITH ARCHITECT (TYP.)
— UP/DN/STOP CONTROL STATION WIRED AND
INSTALLED BY E.C. - COORDINATE EXACT
LOCATION CONTROLLER WITH ARCHITECT (TYP.).

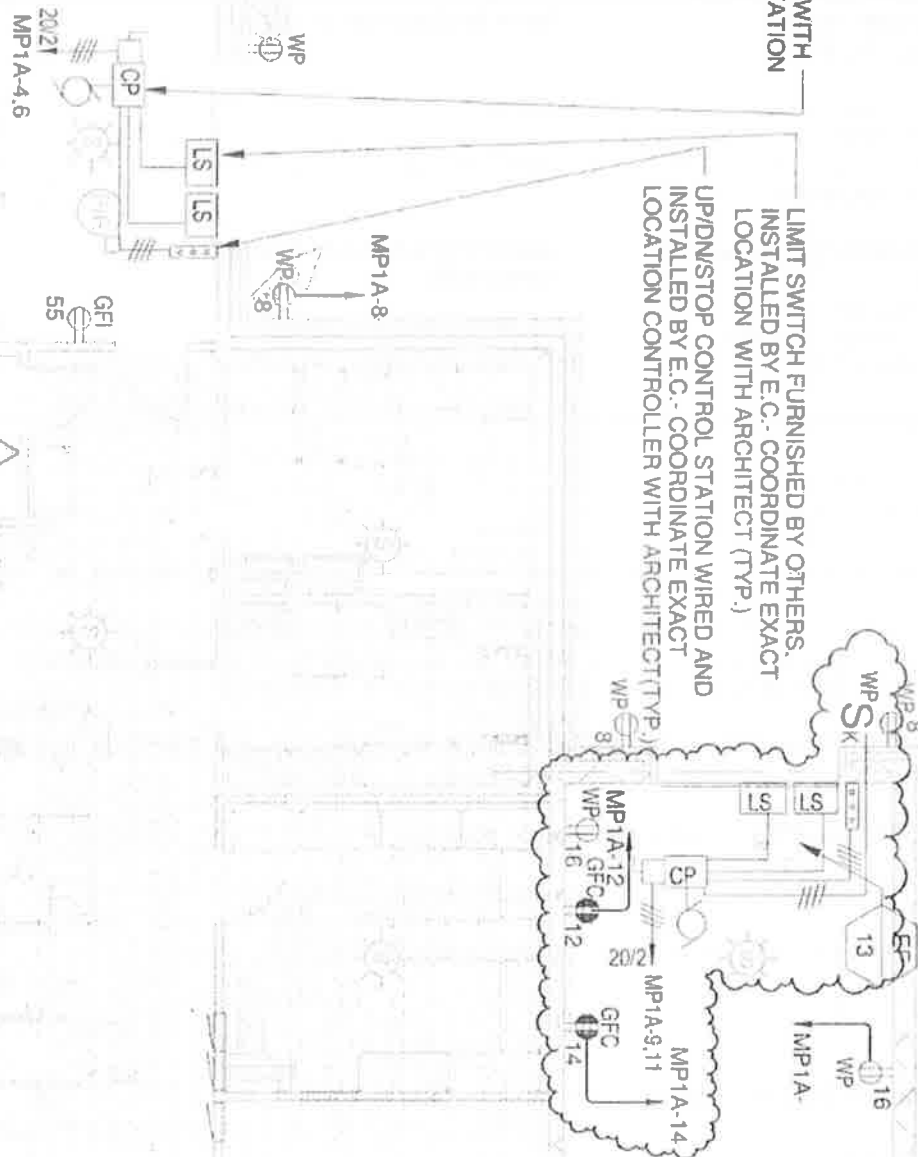

SKE-07

SECTION 083323OVERHEAD COILING DOORS

** Indicates Revision

PART 1 - GENERAL1.1 RELATED DOCUMENTS

- A. Drawings and general provisions of the Contract, including General and Supplementary Conditions and Division 01 Specification Sections, apply to this Section.

1.2 SUMMARY

- A. Section Includes:

1. Insulated and non-insulated service doors.
2. Fire-rated service doors.

- B. Related Requirements:

1. Section 055000 "Metal Fabrications" for miscellaneous steel supports.

1.3 ACTION SUBMITTALS

- A. Product Data: For each type and size of overhead coiling door and accessory.

1. Include construction details, material descriptions, dimensions of individual components, profiles for slats, and finishes.

**

2. Include rated capacities, operating characteristics, electrical characteristics, and furnished accessories.

3. Include description of automatic closing device and testing and resetting instructions.

- B. Shop Drawings: For each installation and for special components not dimensioned or detailed in manufacturer's product data.

1. Include plans, elevations, sections, and mounting details.
2. Include details of equipment assemblies, and indicate dimensions, required clearances, method of field assembly, components, and location and size of each field connection.
3. Include points of attachment and their corresponding static and dynamic loads imposed on structure.
4. For exterior components, include details of provisions for assembly expansion and contraction and for excluding and draining moisture to the exterior.
5. Show locations of controls, locking devices and other accessories.

**

6. Include diagrams for power, signal, and control wiring.

- C. Samples for Initial Selection: Manufacturer's finish charts showing full range of colors and textures available for units with factory-applied finishes.

1. Include similar Samples of accessories involving color selection.

- D. Samples for Verification: For each type of exposed finish on the following components, in

manufacturer's standard sizes:

1. Curtain slats.
2. Bottom bar.
3. Guides.
4. Brackets.
5. Hood.
6. Locking device(s).
7. Include similar Samples of accessories involving color selection.

1.4 INFORMATIONAL SUBMITTALS

- A. Qualification Data: For Installer.
- B. Oversize Construction Certification: For door assemblies required to be fire-rated and that exceed size limitations of labeled assemblies.

1.5 CLOSEOUT SUBMITTALS

- A. Maintenance Data: For overhead coiling doors to include in maintenance manuals.

1.6 QUALITY ASSURANCE

- A. Installer Qualifications: An entity that employs installers and supervisors who are trained and approved by manufacturer for both installation and maintenance of units required for this Project.
 1. Maintenance Proximity: Not more than two hours' normal travel time from Installer's place of business to Project site.
- B. Regulatory Requirements: Comply with applicable provisions in Massachusetts 521 CMR: Architectural Access Board and 2010 ADA Standards for Accessible Design.
- C. Fire-Rated Door Assemblies: Assemblies complying with NFPA 80 that are listed and labeled by a qualified testing agency, for fire-protection ratings indicated, based on testing at as close to neutral pressure as possible according to NFPA 252 or UL 10B.
 1. Oversize Fire-Rated Door Assemblies: For units exceeding sizes of tested assemblies, provide certification by a qualified testing agency that doors comply with standard construction requirements for tested and labeled fire-rated door assemblies except for size.
 2. Temperature-Rise Limit: At exit enclosures and exit passageways, provide doors that have a maximum transmitted temperature end point of not more than 450 deg F (250 deg C) above ambient after 30 minutes of standard fire-test exposure.
 3. Smoke Control: In corridors and smoke barriers, provide doors that are listed and labeled with the letter "S" on the fire-rating label by a qualified testing agency for smoke- and draft-control based on testing according to UL 1784; with maximum air-leakage rate of 3.0 cfm/sq. ft. (0.01524 cu. m/s x sq. m) of door opening at 0.10-inch wg (24.9 Pa) for both ambient and elevated temperature tests.

PART 2 - PRODUCTS

2.1 MANUFACTURERS, GENERAL

- A. Source Limitations: Obtain overhead coiling doors from single source from single manufacturer.

1. Obtain operators and controls from overhead coiling door manufacturer.

2.2 PERFORMANCE REQUIREMENTS

- A. Structural Performance, Exterior Doors: Capable of withstanding the design wind loads.
 1. Design Wind Load: As indicated on Drawings.
 2. Testing: According to ASTM E 330.
 3. Deflection Limits: Design overhead coiling doors to withstand design wind load without evidencing permanent deformation or disengagement of door components.
 4. Operability under Wind Load: Design overhead coiling doors to remain operable under design wind load, acting inward and outward.
- B. Seismic Performance: Overhead coiling doors shall withstand the effects of earthquake motions determined according to ASCE/SEI 7.
 1. Component Importance Factor: 1.5.

2.3 INSULATED DOOR ASSEMBLY

- A. Insulated Service Door: Overhead coiling door formed with curtain of interlocking metal slats.
 1. Manufacturers: Subject to compliance with requirements, provide products by one of the following:
 - a. Alpine Overhead Doors, Inc.
 - b. Cookson Company.
 - c. Cornell Iron Works, Inc.
 - d. McKeon Rolling Steel Door Company, Inc.
 - e. Overhead Door Corporation.
 - f. Raynor.
 - g. Wayne-Dalton Corp.
- B. Operation Cycles: Door components and operators capable of operating for not less than 100,000. One operation cycle is complete when a door is opened from the closed position to the fully open position and returned to the closed position.
 1. Include tamperproof cycle counter.
- C. Air Infiltration: Maximum rate of 0.08 cfm/sq. ft. (0.406 L/s per sq. m) at 15 and 25 mph (24.1 and 40.2 km/h) when tested according to ASTM E 283.
- D. Curtain R-Value: 6.0 deg F x h x sq. ft./Btu (1.057 K x sq. m/W).
- E. Door Curtain Material: Aluminum.
- F. Door Curtain Slats: Flat profile slats of 2-5/8-inch (67-mm) center-to-center height.
 1. Insulated-Slat Interior Facing: Metal.
 2. Gasket Seal: Manufacturer's standard continuous gaskets between slats.
- G. Bottom Bar: Two angles, each not less than 1-1/2 by 1-1/2 by 1/8 inch (38 by 38 by 3 mm) thick, fabricated from stainless steel or aluminum extrusions and finished to match door.
- H. Curtain Jamb Guides: Stainless steel with exposed finish matching curtain slats.

- I. Hood: Match curtain material and finish.
 - 1. Shape: Round.
 - 2. Mounting: As shown on Drawings.
- J. Locking Devices: Equip door with locking device assembly.
 - 1. Locking Device Assembly: Cremone type, both jamb sides locking bars, operable inside and outside with cylinders.

**

~~K. Manual Door Operator: Push-up operation.~~

L. Electric Door Operator:

- 1. Usage Classification: Standard duty, up to 25 cycles per hour and up to 90 cycles per day.
- 2. Operator Location: As shown on Drawings.
- 3. Safety: Listed according to UL 325 by a qualified testing agency for commercial or industrial use; moving parts of operator enclosed or guarded if exposed and mounted at 8 feet (2.44 m) or lower.
- 4. Motor Exposure: Exterior, wet, and humid.
- 5. Emergency Manual Operation: Push-up type.
- 6. Obstruction-Detection Device: Automatic electric sensor edge on bottom bar.
 - a. Sensor Edge Bulb Color: As selected by Architect from manufacturer's full range.
- 7. Control Station(s): Interior mounted.

- M. Curtain Accessories: Equip door with weatherseals, push/pull handles and pull-down strap.
- N. Door Finish:
 - 1. Baked-Enamel or Powder-Coated Finish: Color as selected by Architect from manufacturer's full range.
 - 2. Interior Curtain-Slat Facing: Match finish of exterior curtain-slat face.

2.4 UNINSULATED DOOR ASSEMBLY

- A. Insulated Service Door: Overhead coiling door formed with curtain of interlocking metal slats.
 - I. Manufacturers: Subject to compliance with requirements, provide products by one of the following:
 - a. Alpine Overhead Doors, Inc.
 - b. Cookson Company.
 - c. Cornell Iron Works, Inc.
 - d. McKeon Rolling Steel Door Company, Inc.
 - e. Overhead Door Corporation.
 - f. Raynor.
 - g. Wayne-Dalton Corp.
- B. Operation Cycles: Door components and operators capable of operating for not less than 100,000. One operation cycle is complete when a door is opened from the closed position to the fully open position and returned to the closed position.

1. Include tamperproof cycle counter.
- C. Door Curtain Material: Aluminum
- D. Door Curtain Slats: Flat profile slats of 2-5/8-inch (67-mm) center-to-center height.
- E. Bottom Bar: Two angles, each not less than 1-1/2 by 1-1/2 by 1/8 inch (38 by 38 by 3 mm) thick; fabricated from stainless steel or aluminum extrusions and finished to match door.
- F. Curtain Jamb Guides: Stainless steel with exposed finish matching curtain slats.
- G. Hood: Match curtain material and finish.
 1. Shape: Round.
 2. Mounting: As shown on Drawings.
- H. Locking Devices: Equip door with locking device assembly.
 1. Locking Device Assembly: Cremone type, both jamb sides locking bars, operable inside and outside with cylinders.

**

I. Manual Door Operator - Push-up operation

J. Electric Door Operator:

1. Usage Classification: Standard duty, up to 25 cycles per hour and up to 90 cycles per day.
2. Operator Location: As shown on Drawings.
3. Safety: Listed according to UL 325 by a qualified testing agency for commercial or industrial use; moving parts of operator enclosed or guarded if exposed and mounted at 8 feet (2.44 m) or lower.
4. Motor Exposure: Interior.
5. Emergency Manual Operation: Push-up type.
6. Obstruction-Detection Device: Automatic electric sensor edge on bottom bar.
 - a. Sensor Edge Bulb Color: As selected by Architect from manufacturer's full range.
7. Control Station(s): Interior mounted.

K. Door Finish:

1. Baked-Enamel or Powder-Coated Finish: Color as selected by Architect from manufacturer's full range.

2.5 FIRE-RATED DOOR ASSEMBLY

- A. Fire-Rated Service Door: Overhead fire-rated coiling door formed with curtain of interlocking metal slats.
 1. Basis-of-Design Product: Subject to compliance with requirements, provide Model #635; Overhead Door Corporation or comparable product by one of the following:
 - a. Alpine Overhead Doors, Inc.
 - b. C.H.I. Overhead Doors.

- c. Cookson Company.
- d. Cornell Iron Works, Inc.
- e. McKeon Rolling Steel Door Company, Inc.
- f. Raynor.
- g. Southwestern Rolling Steel Door Co.
- h. Wayne-Dalton Corp.

B. Operation Cycles: Door components and operators capable of operating for not less than 50,000. One operation cycle is complete when a door is opened from the closed position to the fully open position and returned to the closed position.

- 1. Include tamperproof cycle counter.

C. Fire Rating: 4 hours with temperature-rise limit and with smoke control.

D. Door Curtain Material: Galvanized steel.

E. Door Curtain Slats: Flat profile slats of 2-5/8-inch (67-mm) center-to-center height.

F. Curtain Jamb Guides: Galvanized steel with exposed finish matching curtain slats.

G. Hood: Galvanized steel.

- 1. Shape: Square.
- 2. Mounting: Between jambs.

**

H. Manual Door Operator: Push-up operation

1. Provide operator with through-wall shaft operation.

2. Provide operator with manufacturer's standard removable operating arm.

I. Electric Door Operator:

1. Usage Classification: Standard duty, up to 25 cycles per hour and up to 90 cycles per day.

2. Operator Location: As shown on Drawings.

3. Safety: Listed according to UL 325 by a qualified testing agency for commercial or industrial use; moving parts of operator enclosed or guarded if exposed and mounted at 8 feet (2.44 m) or lower.

4. Motor Exposure: Interior.

5. Emergency Manual Operation: Push-up type.

6. Obstruction-Detection Device: Automatic electric sensor edge on bottom bar.

a. Sensor Edge Bulb Color: As selected by Architect from manufacturer's full range.

7. Control Station(s): Interior mounted.

J. Door Finish:

- 1. Baked-Enamel or Powder-Coated Finish: Custom color matching Architect's sample.
- 2. Interior Curtain-Slat Facing: Match finish of exterior curtain-slat face.

2.6 DOOR CURTAIN MATERIALS AND CONSTRUCTION

A. Door Curtains: Fabricate overhead coiling-door curtain of interlocking metal slats, designed to

withstand wind loading indicated, in a continuous length for width of door without splices. Unless otherwise indicated, provide slats of thickness and mechanical properties recommended by door manufacturer for performance, size, and type of door indicated, and as follows:

1. Aluminum Door Curtain Slats: ASTM B 209 (ASTM B 209M) sheet or ASTM B 221 (ASTM B 221M) extrusions, alloy and temper standard with manufacturer for type of use and finish indicated; thickness of 0.050 inch (1.27 mm); and as required.
 2. Insulation: Fill slats for insulated doors with manufacturer's standard thermal insulation complying with maximum flame-spread and smoke-developed indexes of 75 and 450, respectively, according to ASTM E 84 or UL 723. Enclose insulation completely within slat faces.
 3. Metal Interior Curtain-Slat Facing: Match metal of exterior curtain-slat face, with minimum aluminum thickness of 0.032 inch (0.80 mm).
- B. Curtain Jamb Guides: Manufacturer's standard angles or channels and angles of same material and finish as curtain slats unless otherwise indicated, with sufficient depth and strength to retain curtain, to allow curtain to operate smoothly, and to withstand loading. Slot bolt holes for guide adjustment. Provide removable stops on guides to prevent overtravel of curtain, and a continuous bar for holding windlocks.

2.7 HOODS

- A. General: Form sheet metal hood to entirely enclose coiled curtain and operating mechanism at opening head. Contour to fit end brackets to which hood is attached. Roll and reinforce top and bottom edges for stiffness. Form closed ends for surface-mounted hoods and fascia for any portion of between-jamb mounting that projects beyond wall face. Equip hood with intermediate support brackets as required to prevent sagging.
1. Aluminum (Non Fire Rated): 0.040-inch- (1.02-mm-) thick aluminum sheet complying with ASTM B 209 (ASTM B 209M), of alloy and temper recommended by manufacturer and finisher for type of use and finish indicated.
 2. Galvanized Steel (Fire Rated): Nominal 0.028-inch- (0.71-mm-) thick, hot-dip galvanized steel sheet with G90 (Z275) zinc coating, complying with ASTM A 653/A 653M.
 - a. Include automatic drop baffle on fire-rated doors to guard against passage of smoke or flame.

2.8 LOCKING DEVICES

- ~~A. Slide Bolt: Fabricate with side-locking bolts to engage through slots in tracks for locking by padlock, located on both left and right jamb sides, operable from coil side.~~
- ~~B. Locking Device Assembly: Fabricate with cylinder lock, spring-loaded dead bolt, operating handle, cam plate, and adjustable locking bars to engage through slots in tracks.~~
- ~~1. Lock Cylinders: Cylinders specified in Section 087100 "Door Hardware" and keyed to building keying system.~~
- ~~2. Keys: Three for each cylinder.~~
- C. Safety Interlock Switch: Equip power-operated doors with safety interlock switch to disengage power supply when door is locked.

2.9 CURTAIN ACCESSORIES

- A. Weatherseals for Exterior Doors: Equip each exterior door with weather-stripping gaskets fitted

to entire exterior perimeter of door for a weather-resistant installation unless otherwise indicated.

1. At door head, use 1/8-inch- (3-mm-) thick, replaceable, continuous-sheet baffle secured to inside of hood or field- installed on the header.
 2. At door jambs, use replaceable, adjustable, continuous, flexible, 1/8-inch- (3-mm-) thick seals of flexible vinyl, rubber, or neoprene.
- B. Smoke Seals: Equip each fire-rated door with replaceable smoke-seal perimeter gaskets or brushes for smoke and draft control as required for door listing and labeling by a qualified testing agency.
- C. Push/Pull Handles: Equip each push-up-operated or emergency-operated door with lifting handles on each side of door, finished to match door.
- D. Pull-Down Strap: Provide pull-down straps for doors more than 84 inches (2130 mm) high.
- E. Automatic-Closing Device for Fire-Rated Doors: Equip each fire-rated door with an automatic-closing device or holder-release mechanism and governor unit complying with NFPA 80 and an easily tested and reset release mechanism. Testing for manually operated doors shall allow resetting by opening the door without retensioning the counterbalancing. Automatic-closing device shall be designed for activation by the following:
1. Manufacturer's standard UL-labeled smoke detector and door-holder-release devices.
 2. Building fire-detection, smoke-detection, and -alarm systems.

2.10 COUNTERBALANCING MECHANISM

- A. General: Counterbalance doors by means of manufacturer's standard mechanism with an adjustable-tension, steel helical torsion spring mounted around a steel shaft and contained in a spring barrel connected to top of curtain with barrel rings. Use grease-sealed bearings or self-lubricating graphite bearings for rotating members.
- B. Counterbalance Barrel: Fabricate spring barrel of manufacturer's standard hot-formed, structural-quality, seamless or welded carbon-steel pipe, of sufficient diameter and wall thickness to support rolled-up curtain without distortion of slats and to limit barrel deflection to not more than 0.03 in./ft. (2.5 mm/m) of span under full load.
- C. Counterbalance Spring (Fire Rated): One or more oil-tempered, heat-treated steel helical torsion springs. Size springs to counterbalance weight of curtain, with uniform adjustment accessible from outside barrel. Secure ends of springs to barrel and shaft with cast-steel barrel plugs.
1. Fire-Rated Doors: Equip with auxiliary counterbalance spring and prevent tension release from main counterbalance spring when automatic closing device operates.
- D. Brackets: Manufacturer's standard mounting brackets of either cast iron or cold-rolled steel plate.
- **

2.11 MANUAL DOOR OPERATORS

- A. General: Equip door with manual door operator by door manufacturer.
- B. Push-up Door Operation: Lift handles and pull rope for raising and lowering doors, with counterbalance mechanism designed so that required lift or pull for door operation does not exceed 25 lbf (111 N).

2.12 ELECTRIC DOOR OPERATORS

- A. General: Electric door operator assembly of size and capacity recommended and provided by door manufacturer for door and operation-cycles requirement specified, with electric motor and factory-prewired motor controls, starter, gear-reduction unit, solenoid-operated brake, clutch, control stations, control devices, integral gearing for locking door, and accessories required for proper operation.
 - 1. Manufacturers: Subject to compliance with requirements, available manufacturers offering products that may be incorporated into the Work include, but are not limited to, the following:
 - a. Chamberlain Group, Inc. (The).
 - 2. Comply with NFPA 70.
 - 3. Control equipment complying with NEMA ICS 1, NEMA ICS 2, and NEMA ICS 6, with NFPA 70 Class 2 control circuit, maximum 24-V ac or dc.
- B. Usage Classification: Electric operator and components capable of operating for not less than number of cycles per hour indicated for each door.
- C. Door Operator Location(s): Operator location indicated for each door.
 - 1. Top-of-Hood Mounted: Operator is mounted to the right or left door head plate with the operator on top of the door-hood assembly and connected to the door drive shaft with drive chain and sprockets. Headroom is required for this type of mounting.
- D. Motors: Reversible-type motor with controller (disconnect switch) for motor exposure indicated.
 - 1. Electrical Characteristics:
 - a. Phase: Single phase.
 - b. Volts: 115 V.
 - c. Hertz: 60.
- E. Motor Size: Minimum size as indicated. If not indicated, large enough to start, accelerate, and operate door in either direction from any position, at a speed not less than 8 in./sec. (203 mm/s) and not more than 12 in./sec. (305 mm/s), without exceeding nameplate ratings or service factor.
- F. Operating Controls, Controllers, Disconnect Switches, Wiring Devices, and Wiring: Manufacturer's standard unless otherwise indicated.
- G. Coordinate wiring requirements and electrical characteristics of motors and other electrical devices with building electrical system and each location where installed.
- H. Limit Switches: Equip each motorized door with adjustable switches interlocked with motor controls and set to automatically stop door at fully opened and fully closed positions.
- I. Obstruction Detection Devices: External entrapment protection consisting of indicated automatic safety sensor capable of protecting full width of door opening. For non-fire-rated doors, activation of device immediately stops and reverses downward door travel. For fire-rated doors, activation delays closing.
 - 1. Electric Sensor Edge: Automatic safety sensor edge, located within astragal or weather stripping mounted to bottom bar. Contact with sensor activates device. Connect to control circuit using manufacturer's standard take-up reel or self-coiling cable.

- a. Self-Monitoring Type: Four-wire configured device designed to interface with door operator control circuit to detect damage to or disconnection of sensor edge.
- J. Control Station: Three-button control station in fixed location with momentary-contact push-button controls labeled "Open" and "Stop" and sustained- or constant-pressure push-button control labeled "Close."
 - 1. Interior-Mounted Units: Full-guarded, surface-mounted, heavy-duty type, with general-purpose NEMA ICS 6, Type 1 enclosure.
 - 2. Exterior-Mounted Units: Full-guarded, standard-duty, surface-mounted, weatherproof type, NEMA ICS 6, Type 4 enclosure, key operated.
- K. Emergency Manual Operation: Equip each electrically powered door with capability for emergency manual operation. Design manual mechanism so required force for door operation does not exceed 25 lbf (111 N).
- L. Emergency Operation Disconnect Device: Equip operator with hand-operated disconnect mechanism for automatically engaging manual operator and releasing brake for emergency manual operation while disconnecting motor without affecting timing of limit switch. Mount mechanism so it is accessible from floor level. Include interlock device to automatically prevent motor from operating when emergency operator is engaged.
- AI. Motor Removal: Design operator so motor may be removed without disturbing limit-switch adjustment and without affecting emergency manual operation.
- N. Audible and Visual Signals: Audible alarm and visual indicator lights in compliance with regulatory requirements for accessibility.

2.13 GENERAL FINISH REQUIREMENTS

- A. Comply with NAAMM/NOMMA's "Metal Finishes Manual for Architectural and Metal Products (AMP 500-06)" for recommendations for applying and designating finishes.
- B. Appearance of Finished Work: Noticeable variations in same piece are not acceptable. Variations in appearance of adjoining components are acceptable if they are within the range of approved Samples and are assembled or installed to minimize contrast.

2.14 ALUMINUM FINISHES

- A. Baked-Enamel or Powder-Coat Finish: AAMA 2603. Comply with coating manufacturer's written instructions for cleaning, conversion coating, application, and baking.

2.15 STEEL AND GALVANIZED-STEEL FINISHES

- A. Baked-Enamel or Powder-Coat Finish: Manufacturer's standard baked-on finish consisting of prime coat and thermosetting topcoat. Comply with coating manufacturer's written instructions for cleaning, pretreatment, application, and minimum dry film thickness.

2.16 STAINLESS-STEEL FINISHES

- A. Surface Preparation: Remove tool and die marks and stretch lines, or blend into finish.
- B. Polished Finishes: Grind and polish surfaces to produce uniform finish, free of cross scratches.
 - 1. Run grain of directional finishes with long dimension of each piece.

2. When polishing is completed, passivate and rinse surfaces. Remove embedded foreign matter and leave surfaces chemically clean.
3. Directional Satin Finish: No. 4.

PART 3 - EXECUTION

3.1 EXAMINATION

- A. Examine substrate areas and conditions, with Installer present, for compliance with requirements for substrate construction and other conditions affecting performance of the Work.
- B. Examine locations of electrical connections.
- C. Proceed with installation only after unsatisfactory conditions have been corrected.

3.2 INSTALLATION

- A. Install overhead coiling doors and operating equipment complete with necessary hardware, anchors, inserts, hangers, and equipment supports: according to manufacturer's written instructions and as specified.
- B. Install overhead coiling doors, hoods, controls, and operators at the mounting locations indicated for each door.
- C. Accessibility: Install overhead coiling doors, switches, and controls along accessible routes in compliance with regulatory requirements for accessibility.
- D. Fire-Rated Doors: Install according to NFPA 80.
- E. Smoke-Control Doors: Install according to NFPA 80 and NFPA 105.

**

F. Power-Operated Doors: Install according to UL 325.

3.3 STARTUP SERVICE

- A. Engage a factory-authorized service representative to perform startup service.
 1. Perform installation and startup checks according to manufacturer's written instructions.
 2. Test and adjust controls and safety devices. Replace damaged and malfunctioning controls and equipment.
 3. Test door closing when activated by detector or alarm-connected fire-release system. Reset door-closing mechanism after successful test.

3.4 ADJUSTING

- A. Adjust hardware and moving parts to function smoothly so that doors operate easily, free of warp, twist, or distortion.
 1. Adjust exterior doors and components to be weather-resistant.
- B. Lubricate bearings and sliding parts as recommended by manufacturer.
- C. Adjust seals to provide tight fit around entire perimeter.

3.5 MAINTENANCE SERVICE

- A. Initial Maintenance Service: Beginning at Substantial Completion, maintenance service shall include three months' full maintenance by skilled employees of coiling-door Installer. Include monthly preventive maintenance, repair or replacement of worn or defective components, lubrication, cleaning, and adjusting as required for door operation. Parts and supplies shall be manufacturer's authorized replacement parts and supplies.
1. Perform maintenance, including emergency callback service, during normal working hours.
 2. Include 24-hour-per-day, seven-day-per-week, emergency callback service.

3.6 DEMONSTRATION

- A. Engage a factory-authorized service representative to train Owner's maintenance personnel to adjust, operate, and maintain overhead coiling doors.

END OF SECTION 083323



Change Request BT180

To: William Cunniff
Joslin Lesser & Assoc
44 Pleasant Street
Watertown, MA 02472

Date: February 29, 2016
Project #: 131411
Project: MSBA - Haverhill Caleb Dustin MS

Description: HM Door Frame Changes per CCD-09

Item Description	Amount
Galeno; HM Door Frame Changes per CCD-09	\$22,928
GVW; HM Door Frame Changes per CCD-09	\$6,601
HM Door Frame Changes per CCD-09	\$(29,529)
Total:	\$0

Type: Lump sum proposal
Schedule Impact: This change will add 0 day(s) to the contract completion date.
Overtime: Project OT Not Required
Notes:

By: Katy Lillich, JCJ Architecture, Inc.

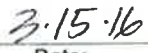
Date:

By: Joseph Pollock, Shawmut Design & Construction

Date:

By: William Cunniff, Joslin Lesser & Assoc

Date:

SOC PCT NUMBER: 1-23-16

PCT DESC:

CCD - 09

FIRM SUBMITTING CHANGE REQUEST: CHEN Associates

4. LUMP SUM SERVICES PROVIDED TO SUBCONTRACTOR (Not Typical. Contact GC for Direction):

Description of Lump Sum Service attach backup	Total
	\$
	\$
	\$
	\$
	\$
TOTAL LUMP SUM SERVICES COST:	\$

5. SUBTOTAL OF SUBCONTRACTOR'S DIRECT COSTS (ITEMS 1, 2, 3, and 4)

\$ 29,844.33

6. SUBCONTRACTOR'S ALLOWED O&P MARK-UP ON ALLOWABLE DIRECT COSTS (10% OF ITEM 5)

\$ 2,984.43

10.00%

7. INSURANCE AND TAXES ON SUBCONTRACTOR BASE LABOR ONLY:

Total Base Wages Subject to Social Security and Taxes from Item 1 above
Insurance & Taxes Rate (30%, or as approved by R.A.P. APPROVED BY R.A.P. (PCT) FORM 7)

30.00%

TOTAL COST INSURANCE AND TAXES ON LABOR

\$ N/A

8.

TOTAL COST OF WORK PERFORMED BY SUBCONTRACTOR (ITEMS 5, 6, and 7):

\$ 32,828.76

9.

TOTAL COST OF WORK PERFORMED BY SUB-SUBCONTRACTORS (Item 7 on attached Sub-Sub Form):

\$ N/A

10.

** ALLOWABLE MARKUP ON SUB-SUBCONTRACTOR'S WORK (By Contract, 10% of Item 5 on attached Sub-Sub Form)

\$ N/A

11.

TOTAL COST OF WORK INCLUDED IN THIS CHANGE REQUEST (ITEMS 8, 9, 10):

\$ N/A

12. SUBCONTRACTOR BOND

Approved Subcontractor (Attach Subcontractor's Item 11)

\$ N/A ITEM 11:

13.

TOTAL CHANGE PROPOSAL AMOUNT, including bond cost

\$ 22,928.76

Additional Notice:

Change proposals must include a cover letter on company letterhead identifying the PCT number, a description of the scope of work and the total cost of the Change Request.

** By Contract, the maximum aggregate mark-up allowed on direct allowable costs is 10%, and may be shared between Sub and Sub-Subs, where applicable.

Galeno & Associates, Inc.

83 Eastman Street

P.O. Box 1157

So. Easton, Ma. 02334 - 1157

Tel: 508-238-5083

Fax: 508-238-5028

2-2-16

Shawmut Design & Construction

RE: Caleb Dustin Hunking School

Change order:

PER DIRECTIVE NUMBER 009 DATED 1-25-16

ADDED HOLLOW METAL FRAMES:

OPENING # A111 [TYPE 7]	\$ 936.00
OPENING # A112B [TYPE 7]	\$ 936.00
OPENING # C137A [TYPE 7]	\$ 936.00
OPENING # C142 [TYPE 11]	\$ 3,008.00
OPENING # A223 [TYPE 1]	\$ 202.00
OPENING # B214A [TYPE 1]	\$ 202.00
OPENING # B216 [TYPE 8]	\$ 936.00
OPENING # B229 [TYPE 9]	\$ 1,924.00
OPENING # B229A [TYPE 9]	\$ 1,924.00
OPENING # B231 [TYPE 11]	\$ 3,008.00
OPENING # B235 [TYPE 11]	\$ 3,008.00
OPENING # C253 [TYPE 10]	\$ 1,224.00

TOTAL MATERIAL COST \$ 18,244.00

FREIGHT \$ 2,600.00

TOTAL COST \$ 20,844.00 Delivered.

10% OVERHEAD & PROFIT \$ 2,084.00

TOTAL CHANGE ORDER DUE \$ 22,928.00

Quoted by: Allen Matthews

A written purchase order is required for release of materials.

SUBCONTRACTOR CHANGE REQUEST

Lower-tier Subs. Use SUB-
SUBCONTRACTOR Form, NOT this form

Caleb Dustin Hunking School	PROJ. NO.	131411	C.M.	Shawmut Design & Construction
SDC PCI NUMBER:		CCD #000	Add an additional 2,144 inches of polishing and 21.38 sq. ft. of 1/2" clear tempered glass and 11 stock lengths of channel for frames noted in SDC app. D-let-e sq. ft. of 1/4" clear tempered glass	
DATE:				
FIRM SUBMITTING CHANGE REQUEST:		Aluminum & Glass Concepts, Inc.		

1. DIRECT LABOR: SUBCONTRACTOR and/or SUB-SUBCONTRACTOR:

Use only Prevaling Wage Rates or Owner Approved Wages and Rates
 Every work performed by a foreign subsidiary labor rates must be approved by the Owner prior to executing any changes and these costs presented on a Sub Schedule on a Change Report Form

Trade	Classification (Foreman, Journeyman, Apprentice)	Total Hrs. Worked	These values shall be taken from the "Rate Approval Pricing Form" after its approval by the CM and Owner or the Prevailing Wage Table in the specifications.				Total Labor Cost (Wages + Fringe only)
			Hourly Labor Rate (Base + Fringe): (Item I from Rate Approval Pricing Form OR Total Rate from PREVAILING WAGE RATE TABLE)	Total Labor Cost (Wages + Fringe only)	Base Wage Rate for Inclaves (Item D from Rate Approval Pricing Form, or Base Rate from PREVAILING WAGE RATE TABLE)		
Clad	Journeyman - Zone 1	64.00	\$ 70.52	\$ 4,532.48	\$ 42.85	\$ 4,532.48	
				\$		\$	
				\$		\$	
				\$		\$	
				\$		\$	
				\$		\$	
				Total Base Wages	\$ 2,742.40		
				TOTAL BASE and FRINGE DIRECT LABOR COSTS		\$ 4,532.48	

2. MATERIALS: SUBCONTRACTOR:

(For extensive material lists, attach detailed backup and enter as a lump sum below)

Material Description	Qty.	Unit	Cost Per Unit	Total
Clothing Material	179.00	Lm Pa	\$0.35	\$62.65
Multicolored Passenger Accessories	1.00		\$40.00	\$40.00
1" x 1" Channel	5.00	SL's	\$24.00	\$120.00
1" x 2" Channel	6.00	SL's	\$38.00	\$228.00
Poly Bagging Fabric Change for Channels - Estimated	1.00		\$150.00	\$150.00
				\$
				\$
				\$
TOTAL MATERIALS COST:				\$600.65

EQUIPMENT: SUBCONTRACTOR:

(For extensive equipment lists, attach detailed backup and enter as a lump sum below.)

EQUIPMENT: SUBCONTRACTOR:			
(For extensive equipment lists, attach detailed equipment lists, attach detailed equipment and enter as a lump sum amount)			
Equipment Description	Qty	Unit	Cost Per Unit
Total			
			\$
			\$
			\$

SDC PCI NUMBER:
DATE:

PCI DESCRIPTION:

FIRM SUBMITTING CHANGE REQUEST:

4. LUMP SUM SERVICES PROVIDED TO

Description of Lump Sum Service - attach backup	Total
	\$
	\$
	\$
	\$
TOTAL LUMP SUM SERVICES COST:	\$

5. SUBTOTAL OF SUBCONTRACTOR'S DIRECT COSTS (ITEMS 1, 2, 3, and 4)

\$ 5,133.13

6. SUBCONTRACTOR'S ALLOWED O&P MARK-UP ON ALLOWABLE DIRECT COSTS (10% OF ITEM 5)

\$ 513.31

7. INSURANCE AND TAXES ON SUBCONTRACTOR BASE LABOR ONLY:

Total Base Wages Subject to Insurance and Taxes from Item 1 above: \$ 2,742.40
Insurance & Taxes Rate (30%, or as approved on "RATE APPROVAL FILING FORM") 30.00%

TOTAL COST INSURANCE AND TAXES ON LABOR

\$ 822.72

8. TOTAL COST OF WORK PERFORMED BY SUBCONTRACTOR (ITEMS 5, 6, and 7):

\$ 6,469.16

9. TOTAL COST OF WORK PERFORMED BY SUB-SUBCONTRACTOR(S) (Item 7 on attached Sub-Sub Form):

10. ALLOWABLE MARKUP ON SUB-SUBCONTRACTOR'S WORK (By Contract, 10% of Item 5 on attached Sub-Sub Form)

11. TOTAL COST OF WORK INCLUDED IN THIS CHANGE REQUEST (ITEMS 9+10):

\$ 6,469.16

12. SUBCONTRACTOR BOND

Approved bond premium percentage x item 11:

2.041% x ITEM 11: \$ 132.04

13. TOTAL CHANGE PROPOSAL AMOUNT, including bond cost

\$ 6,601.00

Additional Notes:

The CCB pricing accounts for glass changes made in ASI #6

Change proposals must include a cover letter on company letterhead identifying the PCI number, a description of the scope of

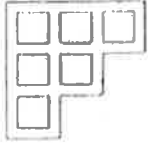

Aluminum & Glass Concepts, Inc

February 5, 2016 (Revised 2/26/16)

Shawmut Design and Construction
560 Harrison Avenue
Boston, MA 02118

ATTN: Joseph Pollock

RE: Caleb Dustin Hunking School
CCD # 009

- Custom Skylights
- Storefronts
- Windows

Per request of Architect through CCD #09, cost breakdown for the changes made are as follows. Please note the below breakdown accounts for the changes made in ASI #6.

Material

Add Glazing Material - 179 Lin. Ft. x .35 per Ft. -----	62.65
Add Miscellaneous Fasteners/Accessories -----	40.00
Add 1" x 1" Channel - 5 SL's @ \$24.00 each -----	120.00
Add 1" x 2" Channel - 6 SL's @ \$38.00 each -----	228.00
Packaging/Crate & Freight Charge for Channels -----	150.00

Labor

Glazier - 64 Hours @ \$70.82 per Hour -----	4,532.48
	5,133.13
10% O & P -----	513.31
	5,646.44
30% Insurance & Taxes on Direct Labor (2,742.40) -----	822.72
	6,469.16
2.041% Bond -----	132.04
	\$6,601.20

Please forward a Change Order for the above amount if we are to proceed.

Sincerely,
ALUMINUM & GLASS CONCEPTS, INC.

Alicia A. Paquin

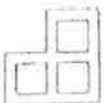



Document G714™ – 2007

Construction Change Directive

PROJECT: (Name and address)

Caleb Dustin Hunking School
98 Winchester Street
Haverhill, MA 01835

DIRECTIVE NUMBER: 009

DATE: January 25, 2016

CONTRACT FOR: General Construction

OWNER: ☐

ARCHITECT: ☐

CONSULTANT: ☐

CONTRACTOR: ☐

FIELD: ☐

OTHER: ☐

TO CONTRACTOR: (Name and address)

Shawmut Design & Construction
560 Harrison Avenue
Boston, MA 02118

CONTRACT DATED: May 14, 2013

ARCHITECT'S PROJECT NUMBER:
B130200.00

You are hereby directed to make the following change(s) in this Contract:

(Describe briefly any proposed changes or list any attached information in the alternative.)

Frame A111 is type 7, per interior elevation 7/A223

Frame A112B is type 7, per interior elevation 1/A210

Frame C137A is type 7, per interior elevation 18/A212

Frame C142 is type 11, per interior elevation 18/A213 and dimension on plan

Frame A223 has LH swing per plan.

Frame B214A is type 1, per interior elevation 2/A219

Frame B216 is type 8, per interior elevation 2/A228 and dimension on plan

Frame B229 is type 9, per interior elevation 8/A220, 1/A228 and dimension on plan

Frame B229A is type 9, per interior elevation 8/A220, 1/A228 and dimension on plan

Frame B231 is type 11, per interior elevation 12/A220 and dimension on plan

Frame B235 is type 11, per interior elevation 16/A220 and dimension on plan

Frame C253 is type 10, per interior elevation 16/A222 and dimension on plan

PROPOSED ADJUSTMENTS

1. The proposed basis of adjustment to the Contract Sum or Guaranteed Maximum Price is:

☐ • Lump Sum decrease of \$0.00

☐ • Unit Price of \$ per

☒ • As provided in Section 7.3.3 of AIA Document A201-2007

☐ • As follows:

2. The Contract Time is proposed to (remain unchanged). The proposed adjustment, if any, is 0 days.

When signed by the Owner and Architect and received by the Contractor, this document becomes effective IMMEDIATELY as a Construction Change Directive (CCD), and the Contractor shall proceed with the change(s) described above.

Contractor signature indicates agreement with the proposed adjustments in Contract Sum and Contract Time set forth in this CCD.

JCJ Architecture
ARCHITECT (Firm name)
One State Street, Suite 900
Boston, MA 02109
ADDRESS

City of Haverhill
OWNER (Firm name)
Four Sumner Street, Room 100
Haverhill, MA 01830
ADDRESS

Shawmut Design & Construction
CONTRACTOR (Firm name)
560 Harrison Avenue
Boston, MA 02118
ADDRESS

BY (Signature)

BY (Signature)

BY (Signature)

Katy Lillich
(Typed name)

(Typed name)

(Typed name)

1-25-16
DATE

DATE

DATE



Change Request CR031

To: William Cunniff
Joslin Lesser & Assoc
44 Pleasant Street
Watertown, MA 02472

Date: March 3, 2016
Project #: 131411
Project: MSBA - Haverhill Caleb Dustin MS

Description: Revise Dimensions of Chiller Support per RFI #59R1

Item Description	Amount
Revise Dimensions of Chiller Support	\$4,613
Fee	\$210
GL Insurance	\$37
Builder's Risk	\$9
Bond	\$37
Total:	\$4,906

Type: Lump sum proposal
Schedule Impact: This change will add 0 day(s) to the contract completion date.
Overtime: Project OT Not Required
Notes:

By: Katy Lillich, JCJ Architecture, Inc.

Date: 3.15.16

By: Joseph Pollock, Shawmut Design & Construction

Date: 3/3/16

By: William Cunniff, Joslin Lesser & Assoc

Date: 3/16/16

CONSTRUCTION MANAGER CHANGE ORDER SUMMARY SHEET

PROJECT#: 131411 - Hunking School
CR#: CR 031
DESCRIPTION: Revise Dimensions of Chiller Support Steel per RFI #59R1
DATE: 03/03/16
REFERENCE: RFI #59R1
CONSTRUCTION MANAGER: Shawmut Design and Construction

SECTION I - SUBCONTRACTORS		Direct Costs	Non-Direct Costs	Total Costs
Beauce Atlas		\$ 4,193.90	\$ 419.10	\$ 4,613
				\$ -
				\$ -
				\$ -
				\$ -
				\$ -
				\$ -
				\$ -
				\$ -
TOTALS		\$ 4,193.90	\$ 419.10	\$ 4,613.00

SECTION II - CM MARK-UPS			Total Costs
Subcontract Direct Costs		\$ 4,193.90	
CM Fee on Direct Costs Only	5.00%	\$ 210.00	
Subcontract Non-Direct Costs		\$ 419.10	
			\$ 4,823
General Liability Insurance	0.76%	\$ 37.00	
Builder's Risk	0.18%	\$ 9.00	
			\$ 4,869
Payment and Performance Bond	0.75%	\$ 37.00	
TOTAL CHANGE ORDER AMOUNT:			\$ 4,906

CR031

Ste-Marie de Beauce, March 3, 2016



Shawmut Design and Consatruction
560 Harrison Avenue
Boston, MA
02118

Change Order Proposal

006 R0

Attention : Mr. Robert Joubert

Project : Caleb Dustin Hunking School
Reference : Chiller changes

Mr. Joubert,

Please find attached cost proposal regarding changes made to the chiller size versus contract drawings. Changes were received after roof beam were erected therefore we had to field weld the connection for the beam connections where the new chiller was sitting.

Excluded:

Notes:

- a) Please refer to attached spreadsheet for details.
- b) This proposal is valid for a period of **14 business days**. Past this period, cost and schedule impact may be subject to reevaluation.

Total cost for this COP :

Total schedule impact for this COP : days

Best Regards,

Alain Metivier
Project Manager

SUBCONTRACTOR CHANGE REQUEST

Lower-tier Subs, Use SUB-
SUBCONTRACTOR Form, NOT this form

Caleb Dustin Hunking School

PROJ. NO. 131411

C.M. Shawmut Design & Construction

SDC PCI NUMBER:

PCI DESC.

DATE: March 1, 2016

Chiller changes

FIRM SUBMITTING CHANGE REQUEST:

Beauce Atlas

1. DIRECT LABOR: SUBCONTRACTOR and/or SUB-SUBCONTRACTOR:

Use only Prevailing Wage Rates or Owner-Approved Wages and Rates

If any work is performed by a lower tier sub, labor rates must be approved by the Owner prior to executing any changes, and those costs presented on a Sub-Subcontractor Change Request Form.

Trade	Classification (Foreman, Journeyman, Apprentice)	Total Hrs. Worked	These values shall be taken from the "Rate Approval Pricing Form", after its approval by the CM and Owner or the Prevailing Wage Table in the specifications.			
			Hourly Labor Rate (Base + Fringe) (Item 1 from Rate Approval Pricing Form OR Total Rate from PREVAILING WAGE RATE TABLE)	Total Labor Cost (Wages + Fringe only)	Base Wage Rate for Ins/Taxes (Item D from Rate Approval Pricing Form, or Base Rate from PREVAILING WAGE RATE TABLE)	Total Labor Cost (Wages + Fringe only)
structural steel	general foreman	0.00	\$ 79.48	\$ -	\$ 49.94	\$ -
structural steel	foreman	0.00	\$ 70.53	\$ -	\$ 40.99	\$ -
structural steel	journey man	0.00	\$ 67.53	\$ -	\$ 37.99	\$ -
structural steel			\$ -	\$ -	\$ -	\$ -
			\$ -	\$ -	\$ -	\$ -
			Total Base Wages		\$ -	\$ -
			TOTAL BASE and FRINGE DIRECT LABOR COSTS		\$ -	\$ -

2. MATERIALS: SUBCONTRACTOR:

(For extensive material lists, attach detailed backup and enter as a lump sum below)

Material Description	Qty	Unit	Cost Per Unit	Total
additional steel (chiller bigger in size than contract drawings)	200.00	I	\$0.65	\$ 130.00
			\$ -	\$ -
			\$ -	\$ -
			\$ -	\$ -
			\$ -	\$ -
			\$ -	\$ -
			TOTAL MATERIALS COST:	
			\$ 130.00	

3. EQUIPMENT: SUBCONTRACTOR:

(For extensive equipment lists, attach detailed backup and enter as a lump sum below)

Equipment Description	Qty	Unit	Cost Per Unit	Total
boom lift 40'	0.00	I	\$ 30.59	\$ -
boom lift 19'	0.00	I	\$ 36.06	\$ -
welding machine	0.00	I	\$ 16.00	\$ -
boom lift 65'	0.00	I	\$ 8.59	\$ -
			TOTAL EQUIPMENT COST:	
			\$ -	

SDC PCI NUMBER:

March 1, 2016

PCI DESC:

Chiller changes

FIRM SUBMITTING CHANGE REQUEST:

Beauce Atlas

4. LUMP SUM SERVICES PROVIDED TO SUBCONTRACTOR (Not Typical. Contact GC for Direction):

Description of Lump Sum Service - attach backup	Total
detailing (4 hours x \$55/hr)	\$ 340.00
	\$ -
	\$ -
TOTAL LUMP SUM SERVICES COST:	\$ 340.00

5. SUBTOTAL OF SUBCONTRACTOR'S DIRECT COSTS (ITEMS 1, 2, 3, and 4) \$ 470.00

6. SUBCONTRACTOR'S ALLOWED O&P MARK-UP ON ALLOWABLE DIRECT COSTS (10% OF ITEM 5) 10.00% \$ 47.00

7. INSURANCE AND TAXES ON SUBCONTRACTOR BASE LABOR ONLY:

Total Base Wages Subject to Insurance and Taxes from Item 1 above
Insurance & Taxes Rate (30%, or as approved on "RATE APPROVAL PRICING FORM")

\$ -
70.64%

TOTAL COST INSURANCE AND TAXES ON LABOR \$ -

8. TOTAL COST OF WORK PERFORMED BY SUBCONTRACTOR (ITEMS 5, 6, and 7): \$ 517.00

9. TOTAL COST OF WORK PERFORMED BY SUB-SUBCONTRACTOR(S) (Item 7 on attached Sub-Sub Form): \$ 3,723.90

10. ** ALLOWABLE MARKUP ON SUB-SUBCONTRACTOR'S WORK (By Contract, 10% of Item 5 on attached Sub-Sub Form) \$ 372.39

11. TOTAL COST OF WORK INCLUDED IN THIS CHANGE REQUEST (ITEMS 9+10): \$ 4,613.29

12. SUBCONTRACTOR BOND
Approved bond premium percentage x item 11: 0.00% x ITEM 11: \$ -

13. TOTAL CHANGE PROPOSAL AMOUNT, including bond cost \$ 4,613.00

Additional Notes:

Change proposals must include a cover letter on company letterhead identifying the PCI number, a description of the scope of work and the total cost of the Change Request.

** By Contract, the maximum aggregate mark-up allowed on direct allowable costs is 10%, and may be shared between Sub and Sub-Subs, where applicable.

SUB-SUBCONTRACTOR CHANGE REQUEST

Project Name: Caleb Dustin Hunking School		PROJ. NO.	131411	C.M.	Shawmut Design & Constructio
PCO NUMBER:	2016-03-02	PCO DESC.	Chiller changes		
FIRM SUBMITTING CHANGE ORDER:		SUB TO:			
		Bessure Atlas			

DIRECT LABOR: SUB-SUBCONTRACTOR:
Use only Prevailing Wage Rates or Owner-Approved Wages and Rates
All Labor Rates must be approved by the Owner prior to issuance of change orders

Trade	Classification (Foreman, Journeyman, Apprentice)	Total Hrs. Worked	These values shall be taken from the "Rate Approval Pricing Form", after its approval by the CM and Owner or the Prevailing Wage Table in the specifications.			
			Hourly Labor Rate (Base + Fringes); (Item I from Wage Approval Sheet OR Total Rate from PREVAILING WAGE RATE TABLE)	Total Labor Cost (Wages + Fringe only)	Base Wage Rate for Inst-Tax (Item D from Wage Approval Sheet, or Base Rate from PREVAILING WAGE RATE TABLE)	Total Labor Cost (Wages + Fringe only)
structural steel	general foreman	0.00	\$ 79.48	\$ -	\$ 49.94	\$ -
structural steel	foreman	0.00	\$ 70.53	\$ -	\$ 40.99	\$ -
structural steel	journey man	28.00	\$ 67.53	\$ 1,890.84	\$ 37.99	\$ 1,890.84
				\$ -		\$ -
				Total Base Wages	\$ 1,063.72	

TOTAL BASE LABOR COSTS (Wages + Fringes only)	\$ 1,890.84
---	-------------

(For extensive material lists, attach detailed backup and enter as a lump sum below)

Material Description	Qty	Unit	Cost Per Unit	Total
			\$	-
			\$	-
			\$	-
			\$	-
			\$	-
			\$	-
			\$	-
			\$	-
			\$	-
			\$	-
TOTAL MATERIALS COST:			\$	-

(For extensive equipment lists, attach detailed backup and enter as a jump sum below)

Equipment Description	Qty	Unit	Cost Per Unit	Total
crane	0.50	l	\$ 825.21	\$ 412.61
welding machine	16.00	l	\$ 16.00	\$ 256.00
TC gun	2.00	l	\$ 6.00	\$ 12.00
25 feet scissor lift	24.00	l	\$ 16.71	\$ 401.04
TOTAL EQUIPMENT COST:			\$	1,081.65

PCO NUMBER: 2016-03-02
DATE:

PCO DESC. Chiller changes

FIRM SUBMITTING CHANGE ORDER:

Beauce Atlas

SUB TO:

4. LUMP SUM SERVICES PROVIDED TO SUB-SUBCONTRACTOR (Not Typical, Contact GC for direction):

Description of Lump Sum Service - attach backup	Total
	\$ -
	\$ -
	\$ -
TOTAL LUMP SUM SERVICES COST:	\$ -

5. SUBTOTAL OF DIRECT COSTS (ITEMS 1, 2, 3, and 4)

\$ 2,972.49

6. INSURANCE AND TAXES ON SUBCONTRACTOR BASE LABOR ONLY:

Total Base Wages Subject to Insurance and Taxes from Item 1 above \$ 1,063.72
Insurance & Taxes Rate (30% or as approved on "RATE APPROVAL PRICING FORM") 70.64%

TOTAL COST INSURANCE AND TAXES ON LABOR \$ 751.41

7.

TOTAL COST OF WORK PERFORMED BY SUB-SUBCONTRACTOR: \$ 3,723.90

Additional Notes:

All change proposals must include a cover letter on company letterhead identifying the PCI number, a description of the scope of work and the total cost of the proposed change order. **
NOTE: Total allowable markup of Direct Costs, per Contract, is 10%, and will be identified on the First-tier Subcontractor's Change Request Form. **

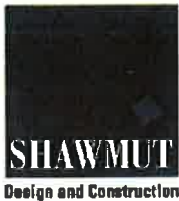

Change Request CR064

To: William Cunniff
Joslin Lesser & Assoc
44 Pleasant Street
Watertown, MA 02472

Date: March 1, 2016
Project #: 131411
Project: MSBA - Haverhill Caleb Dustin MS

Description: Add Backflow Preventer at Water Meter per CCD-08R1

Item Description	Amount
Add Backflow Preventer at Water Meter per CCD-08R1per CCD-08	\$12,608
Fee	\$522
GL Insurance	\$100
Builder's Risk	\$24
Bond	\$99
Total:	\$13,353

Type: Lump sum proposal

Schedule Impact: This change will add 0 day(s) to the contract completion date.

Overtime: Project OT Not Required

Notes:

Add a second backflow preventer and bypass meter per the direction of the Haverhill Water Department

By:  Katy Lillich, JCJ Architecture, Inc.

Date: 3.15.16

By:  Joseph Pollock, Shawmut Design & Construction

Date: 3/1/16

By:  William Cunniff, Joslin Lesser & Assoc

Date: 3/16/16

CONSTRUCTION MANAGER CHANGE ORDER SUMMARY SHEET

PROJECT#: 131411 - Hunking School
CR#: 064
DESCRIPTION: Add a Second Backflow Preventer and Bypass meter per CCD-08R1 as directed by the water department
DATE: 03/01/16
REFERENCE: CCD-08R1
CONSTRUCTION MANAGER: Shawmut Design and Construction

SECTION I - SUBCONTRACTORS		Direct Costs	Non-Direct Costs	Total Costs
E. Amanti		\$ 10,448.30	\$ 2,159.70	\$ 12,608
				\$ -
				\$ -
				\$ -
				\$ -
				\$ -
				\$ -
				\$ -
TOTALS		\$ 10,448.30	\$ 2,159.70	\$ 12,608.00

SECTION II - CM MARK-UPS			Total Costs
Subcontract Direct Costs		\$ 10,448.30	
CM Fee on Direct Costs Only	5.00%	\$ 522.00	
Subcontract Non-Direct Costs		\$ 2,159.70	
			\$ 13,130
General Liability Insurance	0.76%	\$ 100.00	
Builder's Risk	0.18%	\$ 24.00	
			\$ 13,254
Payment and Performance Bond	0.75%	\$ 99.00	
TOTAL CHANGE ORDER AMOUNT:		\$	13,353

CRO64

Change Order Request



C.O.R. # 1524-0009

G.C. #

Date: 12/22/2015

Project Name: Haverhill, Caleb Dustin PLBG

Project #: 1524

To: Shawmut Design and Construction

Attn: Joe Pollock
560 Harrison Avenue

Boston, MA 02118

Phone: (617) 622-7000 Fax: (617) 622-7001

From: E. Amanti & Sons, Inc.

Gary Prescott
390 Highland Ave.
Salem, MA 01970

Phone: (978) 745-4144 Fax: (978) 745-8833

We hereby propose to make the following changes:

Back flow added per RFI 237 response

↳ CCD-8R1

Change Order Price	\$12,608.00
Original Contract Amount	\$1,628,000.00

This price is good for 5 days. If conditions change, this price is void.

We are requesting a time extension of 5 days in conjunction with this change.

Gary Prescott

12/22/2015

Author

Date Sent



Accepted

The above prices and specifications of this Change Order request are satisfactory and are hereby accepted. All work to be performed under same terms and conditions as specified in original contract unless otherwise specified.

Authorized Signature

Date of Acceptance

SUBCONTRACTOR CHANGE REQUEST

Lower-tier Subs, Use SUB-
SUBCONTRACTOR Form, NOT this form

PROJ. NO.

C.M.

Shawmut Design & Construction

SDC PCI NUMBER:

PCI DESC. Pricing per RFI 237 response

DATE: 16.2.29

FIRM SUBMITTING CHANGE REQUEST:

E. Amant & Sons Inc.

1. DIRECT LABOR: SUBCONTRACTOR and/or SUB-SUBCONTRACTOR:

Use only Prevailing Wage Rates or Owner-Approved Wages and Rates

If any work is performed by a lower tier sub, labor rates must be approved by the Owner prior to executing any changes, and those costs presented on a Sub-Subcontractor Change Request Form.

Trade	Classification (Foreman, Journeyman, Apprentice)	Total Hrs. Worked	These values shall be taken from the "REQUEST FOR APPROVAL FOR CHANGE ORDER PRICING" form, after its approval by the CM and Owner				Total Direct Labor Cost
			Total Hourly Labor Costs (Item 1 from Wage-Approval Sheet)	Total Base Cost + Fringe	Wages	Base Wage Rate for Ins/Taxes (Item D from Wage Approval Sheet)	
Plumbing	Journeyman	16.00	\$ 73.59	\$ 1,177.44	\$ 73.59	\$ 73.59	\$ 1,177.44
Plumbing	Foreman	4.00	\$ 83.79	\$ 335.16	\$ 73.59	\$ 73.59	\$ 335.16
				\$ -	\$ -	\$ -	\$ -
				\$ -	\$ -	\$ -	\$ -
				\$ -	\$ -	\$ -	\$ -
Total Base Wages						\$ 1,471.80	
TOTAL BASE and FRINGE DIRECT LABOR COSTS						\$	\$ 1,512.60

2. MATERIALS: SUBCONTRACTOR:

(For extensive material lists, attach detailed backup and enter as a lump sum below)

Material Description	Qty	Unit	Cost Per Unit	Total
3" Watts 957 QT backflow preventer	1.00		\$ 2,343.75	\$ 2,343.75
2" Neptune water meter with strainer and flanges	1.00		\$ 2,799.33	\$ 2,799.33
4" x 3" ductile tee	1.00		\$ 230.00	\$ 230.00
4" x 2" ductile reducer	1.00		\$ 97.00	\$ 97.00
3" x 2" ductile tee	1.00		\$ 134.00	\$ 134.00
3" OSY valves	2.00		\$ 520.00	\$ 1,040.00
4" ductile 90	(1.00)		\$ 211.00	\$ (211.00)
3" bolt and gasket kits	4.00		\$ 11.25	\$ 45.00
2" copper companion flanges	2.00		\$ 141.85	\$ 283.70
2" copper 90	2.00		\$ 17.22	\$ 34.44
2" copper ball valves	2.00		\$ 94.85	\$ 189.70
2" ips companion flanges	2.00		\$ 285.25	\$ 570.50
2" copper x male adapters	2.00		\$ 16.42	\$ 32.84
2" bolt and gasket kit	5.00		\$ 9.85	\$ 49.25
3" copper 90	3.00		\$ 47.95	\$ 143.85
3" x 10' type L copper pipe	1.00		\$ 220.25	\$ 220.25
3" copper flange	1.00		\$ 183.75	\$ 183.75

16.7.79

Pricing per RFI 237 response

E. Amanti & Sons Inc.

3. EQUIPMENT: SUBCONTRACTOR:

(For extensive equipment lists, attach detailed backup and enter as a lump sum below)

Equipment Description	Qty	Unit	Cost Per Unit	Total
			\$	-
			\$	-
			\$	-
			\$	-
			\$	-
TOTAL EQUIPMENT COST:			\$	-

SDC PCI NUMBER:
DATE:

PCI DESC: Pricing per RFI 237 response

FIRM SUBMITTING CHANGE REQUEST:

E. Amanli & Sons Inc.

4. LUMP SUM SERVICES PROVIDED TO SUBCONTRACTOR (Not Typical. Contact GC for Direction):

Description of Lump Sum Service - attach backup	Total
	\$ -
	\$ -
	\$ -
	\$ -
TOTAL LUMP SUM SERVICES COST:	\$ -

5. SUBTOTAL OF SUBCONTRACTOR'S DIRECT COSTS (ITEMS 1, 2, 3, and 4)

\$ 10,448.30

6. SUBCONTRACTOR'S ALLOWED O&P MARK-UP ON ALLOWABLE DIRECT COSTS (10% OF ITEM 5)

\$ 1,044.83

7. INSURANCE AND TAXES ON SUBCONTRACTOR BASE LABOR ONLY:

Insurance & Taxes Rate (12%, or as approved on "REQUEST FOR APPROVAL FOR CHANGE ORDER PRICING" form)

Total Base Wages Subject to Insurance and Taxes from Item 1 above	\$ 1,471.80
	30.00%

TOTAL COST INSURANCE AND TAXES ON LABOR \$ 441.54

8.

TOTAL COST OF WORK PERFORMED BY SUBCONTRACTOR (ITEMS 5, 6, and 7): \$ 11,934.67

9.

TOTAL COST OF WORK PERFORMED BY SUB-SUBCONTRACTOR(S) (Item 7 on attached Sub-Sub Form): \$ 450.29

10.

** ALLOWABLE MARKUP ON SUB-SUBCONTRACTOR'S WORK (By Contract, 10% of Item 5 on attached Sub-Sub Form) \$ 36.97

11.

TOTAL COST OF WORK INCLUDED IN THIS CHANGE REQUEST (ITEMS 9+10): \$ 12,421.93

12. SUBCONTRACTOR BOND

Approved bond premium percentage x Item 11.

1.50% x ITEM 11: \$ 186.33

13.

TOTAL CHANGE PROPOSAL AMOUNT, including bond cost \$ 12,608.00

Additional Notes:

Change proposals must include a cover letter on company letterhead identifying the PCI number, a description of the scope of work and the total cost of the Change Request.

** By Contract, the maximum aggregate mark-up allowed on direct allowable costs is 10%, and may be shared between Sub and Sub-Subs, where applicable.

SUB-SUBCONTRACTOR CHANGE REQUEST

Project Name: CALEB HUNKUNG SCHOOL		PROJ. NO. 131411	C.M. SHAWMUT DESIGN & CONST
PCO NUMBER: RFL-237	DATE: 2/26/2016	PCO DESC. ADDITIONAL BACKFLOW PREVENTER	
FIRM SUBMITTING CHANGE ORDER: INTERSTATE INSULATION LLC		SUB TO: E AMANTI & SONS INC	

1. DIRECT LABOR: SUB-SUBCONTRACTOR:

Use only Prevailing Wage Rates or Owner-Approved Wages and Rates
All Labor Rates must be approved by the Owner prior to issuance of change orders

Trade	Classification (Foreman, Journeyman, Apprentice)	Total Hrs. Worked	These values shall be taken from the "REQUEST FOR APPROVAL FOR CHANGE ORDER PRICING" form, after approval by the CM and Owner				Total Direct Labor Cost
			Total Hourly Labor Costs (Item 1 from Wage Approval Sheet)	Total Base Cost + Fringe	Wages	Base Wage Rate for Ins/Taxes (Item D from Wage Approval Sheet)	
INSULATOR PIPE & TANK	JOURNEYMAN	4.00	\$ 67.16	\$ 268.64			\$ 268.64
				\$ -			\$ -
				\$ -			\$ -
				\$ -			\$ -
				Total Base Wages	\$ -		\$ -

TOTAL BASE, EXCESS AND DIRECT LABOR COSTS \$ 268.64

2. MATERIALS: SUB-SUBCONTRACTOR:

(For extensive material lists, attach detailed backup and enter as a lump sum below)

Material Description	Qty	Unit	Cost Per Unit	Total
fiberglass pipe insulation	12.00	3-1/8x1	\$1.97	\$ 23.64
fg pipe ins	9.00	5-1/8 x 1	\$1.97	\$ 17.73
fg p l	21.00	2-1/8 x 1	\$1.29	\$ 27.09
pvc fitting covers	3.00	no 17-90	\$9.91	\$ 29.73
pvc fitting covers	2.00	no 10-90	\$ 1.44	\$ 2.87
				\$ -
				\$ -
TOTAL MATERIALS COST:				\$ 101.06

3. EQUIPMENT: SUB-SUBCONTRACTOR:

(For extensive equipment lists, attach detailed backup and enter as a lump sum below)

Equipment Description	Qty	Unit	Cost Per Unit	Total
				\$ -
				\$ -
				\$ -
				\$ -
TOTAL EQUIPMENT COST:				\$ -

PCO NUMBER: RFI-237
DATE: 2/26/2016

PCO DESC. ADDITIONAL BACKFLOW PREVENTER

FIRM SUBMITTING CHANGE ORDER:

INTERSTATE INSULATION LLC

SUB TO:

E AMANTI & SONS INC

4. LUMP SUM SERVICES PROVIDED TO SUB-SUBCONTRACTOR (Not Typical, Contact GC for direction):

Description of Lump Sum Service - attach backup	Total
	\$ -
	\$ -
	\$ -
	\$ -
TOTAL LUMP SUM SERVICES COST: \$	

5. SUBTOTAL OF DIRECT COSTS (ITEMS 1, 2, 3, and 4)

\$ 369.70

6. INSURANCE AND TAXES ON SUBCONTRACTOR BASE LABOR ONLY:

Total Base Wages Subject to Insurance and Taxes from Item 1 above \$ 268.64
Insurance & Taxes Rate (12%, or as approved on "REQUEST FOR APPROVAL FOR CHANGE ORDER PRICING" form) 30.00%

TOTAL COST INSURANCE AND TAXES ON LABOR \$ 80.59

7.

TOTAL COST OF WORK PERFORMED BY SUB-SUBCONTRACTOR: \$ 450.29

Additional Notes:

All change proposals must include a cover letter on company letterhead identifying the PCI number, a description of the scope of work and the total cost of the proposed change order.
** NOTE: Total allowable markup of Direct Costs, per Contract, is 10%, and will be identified on the First-tier Subcontractor's Change Request Form. **



AIA[®] Document G714[™] – 2007

Construction Change Directive

PROJECT: <i>(Name and address)</i> Caleb Dustin Hunking School 98 Winchester Street Haverhill, MA 01835	DIRECTIVE NUMBER: 008 DATE: February 12, 2016 CONTRACT FOR: General Construction	OWNER: <input type="checkbox"/> ARCHITECT: <input type="checkbox"/> CONSULTANT: <input type="checkbox"/> CONTRACTOR: <input type="checkbox"/> FIELD: <input type="checkbox"/> OTHER: <input type="checkbox"/>
TO CONTRACTOR: <i>(Name and address)</i> Shawmut Design & Construction 560 Harrison Avenue Boston, MA 02118	CONTRACT DATED: May 14, 2013 ARCHITECT'S PROJECT NUMBER: B130200.00	

You are hereby directed to make the following change(s) in this Contract:
(Describe briefly any proposed changes or list any attached information in the alternative)

Add backflow preventer (RFI 237) and bypass meter (RFI 237R1), attached, and per direction of Plumbing Inspector/Water Department.

PROPOSED ADJUSTMENTS

- The proposed basis of adjustment to the Contract Sum or Guaranteed Maximum Price is:
 - ☐ • Lump Sum decrease of \$0.00
 - ☐ • Unit Price of \$ per
 - ☒ • As provided in Section 7.3.3 of AIA Document A201-2007
 - ☐ • As follows:
- The Contract Time is proposed to (remain unchanged). The proposed adjustment, if any, is 0 days.

When signed by the Owner and Architect and received by the Contractor, this document becomes effective IMMEDIATELY as a Construction Change Directive (CCD), and the Contractor shall proceed with the change(s) described above.

Contractor signature indicates agreement with the proposed adjustments in Contract Sum and Contract Time set forth in this CCD.

JCJ Architecture
ARCHITECT *(Firm name)*
One State Street, Suite 900
Boston, MA 02109
ADDRESS

BY *(Signature)*
Katy Lillich
(Typed name)
2.12.16
DATE

City of Haverhill
OWNER *(Firm name)*
Four Summer Street, Room 100
Haverhill, MA 01830
ADDRESS

BY *(Signature)*

(Typed name)

DATE

Shawmut Design & Construction
CONTRACTOR *(Firm name)*
560 Harrison Avenue
Boston, MA 02118
ADDRESS

BY *(Signature)*

(Typed name)

DATE

GARCIA • GALUSKA • DESOUSA
Consulting Engineers Inc.

REQUEST FOR INFORMATION - RFI

M#50716
J#745 002 00.00

DATE: February 1, 2016
TO: Katy Lillich, RA, MCPPO
JCJ Architecture, Inc.
FROM: Walter J. Araujo

DEPT: Plumbing
PROJECT: Caleb Dustin Hunking School
Haverhill, MA
SUBJECT: RFI #237R1- Water Meter Bypass Requirements

RFI #237R1

The water department is requesting a bypass at the water meter to supply the building while the water meter is being serviced. An extra meter is also being requested to be installed on the bypass. Please advise if this is acceptable and if it is please specify a bypass/meter.

Response:

Install 2" bypass with 2" bypass meter as required by the Water Department. The bypass meter shall be selected by the Water Department.

WJA; map

Enc.

Cc: Suni Dillard, LEED AP, HMFH Architects, Inc.

KKL 02/11/16



Request for Information RFI237R1

RECEIVED

January 28, 2016

Garcia Galuska & DeSousa

Project # 131411
MSBA - Haverhill Caleb Dustin MS

RFI #: RFI237R1

Date Created: January 28, 2016

To:

Katy Lillich
JCJ Architecture, Inc.
1 State Street
Boston MA, 02109

From:

Andrew LaRosa
Shawmut Design & Construction
560 Harrison Avenue
Boston MA, 02118

Subject

Water Meter Bypass Requirements

Source

Cost Impact

Potentially

Amount

\$TBD

Schedule Impact

Potentially

Days

TBD

Question

Date Required: February 04, 2016

The water department is requesting a bypass at the water meter to supply the building while the water meter is being serviced. An extra meter is also being requested to be installed on the bypass. Please advise if this is acceptable and if it is please specify a bypass/ meter.

Suggestion

Answer

Date Answered:

Cc: Company Name

Contact Name

GARCIA • GALUSKA • DESOUSA
Consulting Engineers Inc.

REQUEST FOR INFORMATION - RFI

M#50337
J#745 002 00.00

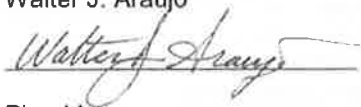
DATE: December 21, 2015
TO: Katy Lillich, RA, MCPPO
JCJ Architecture, Inc.
FROM: Walter J. Araujo

DEPT: Plumbing
PROJECT: Caleb Dustin Hunking School
Haverhill, MA
SUBJECT: RFI #237 – Building Backflow Preventer

RFI #237

Please see the attached RFI from E Amanti. A backflow preventer is shown at the water meter for the irrigation system, this question is asking if a backflow preventer and a bypass is required for the building, please advise.

Is a bypass required for the backflow preventer at the irrigation system?

INFORMATION NEEDED:

The Plumbing Inspector has stated he checked with the Water Dept. and that there is a backflow required after the meter along with a bypass with a backflow in case one needs to be serviced. There is no backflow shown on the drawings at the meter for the building. Are these required? Is there a detail that shows this piping arrangement? Please advise.

Response:

Immediately after the water meter; water line shall rise up to 3" backflow preventer mounted horizontally at 36" A.F.F. Backflow preventer shall be "Watts" model 975-QT reduced pressure backflow preventer or equal. From the outlet of the BFP, increase back to 4" and install submeter WSM-1 and distribution as indicated on Detail 6/P001 "Schematic Water Service Piping". The Water Department does not have a requirement for a bypass.

WJA:sms

Enc.

Cc: Daniel F.B. Ruiz, MCPPO, JCJ Architecture
Christopher M. Garcia, P.E., Garcia, Galuska & DeSousa, Inc.

KKL 12/21/15

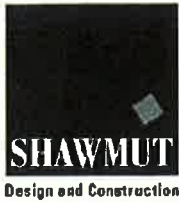

Request for Information RFI237

RECEIVED

December 15, 2015

Garcia Galuska & DeSousa

Project # 131411
MSBA - Haverhill Caleb Dustin MS

RFI #: RFI237

Date Created: December 14, 2015

To:

Katy Lillich
JCJ Architecture, Inc.
1 State Street
Boston MA, 02109

From:

Andrew LaRosa
Shawmut Design & Construction
560 Harrison Avenue
Boston MA, 02118

Subject

Building Backflow Preventer

Source

Cost Impact

Potentially

Amount

\$TBD

Schedule Impact

Potentially

Days

TBD

Question

Date Required: December 21, 2015

Please see the attached RFI from E Amanti. A backflow preventer is shown at the water meter for the irrigation system, this question is asking if a backflow preventer and a bypass is required for the building, please advise.

Is a bypass required for the backflow preventer at the irrigation system?

Suggestion

Answer

Date Answered: ,

Cc: Company Name

Contact Name



Request for Information

E. Amanti & Sons, Inc.

390 Highland Ave.
Salem, MA 01970

RFI # 1524-0021

GC RFI #

Date: 12/11/2015

Phone: (978) 745-4144

Fax: (978) 745-8833

Project Name: Haverhill, Caleb Dustin PLBG

Project #: 1524

To: Shawmut Design and Construction Attn: Joe Pollock 560 Harrison Avenue Boston, MA 02118 Phone: (617) 622-7000 Fax: (617) 622-7001 From: Gary Prescott	<table><tr><th>REASON FOR REQUEST</th><th>ACTION REQUESTED</th><th>PROBABLE EFFECT</th></tr><tr><td><input checked="" type="checkbox"/> Insufficient Information</td><td><input checked="" type="checkbox"/> Clarification</td><td><input type="checkbox"/> Increase Cost</td></tr><tr><td><input type="checkbox"/> Engineering Conflict</td><td><input type="checkbox"/> Direction</td><td><input type="checkbox"/> Decrease Cost</td></tr><tr><td><input type="checkbox"/> Alternate Proposal</td><td><input type="checkbox"/> Approval</td><td><input checked="" type="checkbox"/> Unknown Cost</td></tr><tr><td><input type="checkbox"/></td><td></td><td><input type="checkbox"/> Increase Time</td></tr><tr><td></td><td></td><td><input type="checkbox"/> Decrease Time</td></tr><tr><td colspan="2">RESPONSE REQUIRED BY: 12/18/2015</td><td><input checked="" type="checkbox"/> Unknown Time</td></tr></table>	REASON FOR REQUEST	ACTION REQUESTED	PROBABLE EFFECT	<input checked="" type="checkbox"/> Insufficient Information	<input checked="" type="checkbox"/> Clarification	<input type="checkbox"/> Increase Cost	<input type="checkbox"/> Engineering Conflict	<input type="checkbox"/> Direction	<input type="checkbox"/> Decrease Cost	<input type="checkbox"/> Alternate Proposal	<input type="checkbox"/> Approval	<input checked="" type="checkbox"/> Unknown Cost	<input type="checkbox"/>		<input type="checkbox"/> Increase Time			<input type="checkbox"/> Decrease Time	RESPONSE REQUIRED BY: 12/18/2015		<input checked="" type="checkbox"/> Unknown Time
REASON FOR REQUEST	ACTION REQUESTED	PROBABLE EFFECT																				
<input checked="" type="checkbox"/> Insufficient Information	<input checked="" type="checkbox"/> Clarification	<input type="checkbox"/> Increase Cost																				
<input type="checkbox"/> Engineering Conflict	<input type="checkbox"/> Direction	<input type="checkbox"/> Decrease Cost																				
<input type="checkbox"/> Alternate Proposal	<input type="checkbox"/> Approval	<input checked="" type="checkbox"/> Unknown Cost																				
<input type="checkbox"/>		<input type="checkbox"/> Increase Time																				
		<input type="checkbox"/> Decrease Time																				
RESPONSE REQUIRED BY: 12/18/2015		<input checked="" type="checkbox"/> Unknown Time																				

REFERENCE: DRAWING NO.:

SPECIFICATION NO.: 220000

SUBJECT: Backflow Preventers

INFORMATION NEEDED:

The plumbing inspector has stated he checked with the water dept. and that there is a backflow required after the meter along with a bypass with a backflow in case one needs to be serviced. There is no backflow shown on the drawings at the meter for the building. Are these required? Is there a detail that shows this piping arrangement? Please advise.

RECOMMENDATION:

RESPONSE:

AUTHORIZED SIGNATURE

COMPANY

DATE



Change Request CR078

To: William Cunhiff
Joslin Lesser & Assoc
44 Pleasant Street
Watertown, MA 02472

Date: March 2, 2016
Project #: 131411
Project: MSBA - Haverhill Caleb Dustin MS

Description: Add Structural Steel Beam to support sliding glass partition per CCD-13

Item Description	Amount
Add Structural Steel Beam to support sliding glass partition per CCD-13	\$1,470
Fee	\$54
GL Insurance	\$12
Builder's Risk	\$3
Bond	\$12
Total:	\$1,551

Type: Lump sum proposal
Schedule Impact: This change will add 0 day(s) to the contract completion date.
Overtime: Project OT Not Required
Notes:

By: William Cunhiff, Joslin Lesser & Assoc

3/16/16
Date:

By: Joseph Pollock, Shawmut Design & Construction

3/2/16
Date:

By: Katy Lillich, JCJ Architecture, Inc.

3.15.16
Date:

CONSTRUCTION MANAGER CHANGE ORDER SUMMARY SHEET

PROJECT#: 131411 - Hunking School
CR#: 078
DESCRIPTION: Add Steel Beam to Support Sliding Glass Partition
DATE: 03/02/16
REFERENCE CCD-13
CONSTRUCTION MANAGER: Shawmut Design and Construction

SECTION I - SUBCONTRACTORS		Direct Costs	Non-Direct Costs	Total Costs
SMJ Metal Company		\$ 1,089.16	\$ 380.84	\$ 1,470
				\$ -
				\$ -
				\$ -
				\$ -
				\$ -
				\$ -
				\$ -
TOTALS		\$ 1,089.16	\$ 380.84	\$ 1,470.00

SECTION II - CM MARK-UPS			Total Costs
Subcontract Direct Costs		\$ 1,089.16	
CM Fee on Direct Costs Only	5.00%	\$ 54.00	
Subcontract Non-Direct Costs		\$ 380.84	
			\$ 1,524
General Liability Insurance	0.76%	\$ 12.00	
Builder's Risk	0.18%	\$ 3.00	
			\$ 1,539
Payment and Performance Bond	0.75%	\$ 12.00	
TOTAL CHANGE ORDER AMOUNT:			\$ 1,551

SMJ Metal Company, Inc

CHANGE ORDER AUTHORIZATION

d/b/a Ralph's Blacksmith Shop

No. 9

36 Smith Street

P: 413-586-3535

Include this number on

Northampton, MA 01060

F: 413-587-0350

Change order if accepted

TITLE: CCD # 013

DATE: March 2, 2016

PROJECT: Caleb Dustin Hunking School

REVISIONS: 1
2
3
4

TO: Joseph Pollock
Shawmut Design & Construction
560 Harrison Avenue
Boston, MA 02118

Phone: 617-622-7354

Fax: 617-622-8354

Email: JPollock@shawmut.com

DESCRIPTION OF CHANGE

Furnish & Install additional beam

Item	Description	Qty	Unit Price	Tax Rate	Tax Amount	Net Amount
1	SUBCONTRACTOR CHANGE REQUEST FORM	1	1,470.00			1,470.00
						0.00
						0.00
						0.00
						0.00
						0.00
						0.00
						0.00
						0.00
						0.00
						0.00
						0.00
						0.00
						0.00
						0.00
						0.00

Total Request 1,470.00

ACCEPTANCE

Work will not commence until signed change order and/or written authorization to proceed is provided.

SMJ Metal Company, Inc. reserves its right to re-price raw material costs on any COA older than 30 days when approval to proceed is provided.

Shawmut Design & Construction

SMJ Metal Company, Inc. d/b/a Ralph's Blacksmith

Accepted _____

Accepted _____

Date: _____

Date: March 2, 2016

Description of Lump Sum Service - attach backup	Total
	6

SDC PCI NUMBER:
DATE:

PCI DESC.

CCD-013

FIRM SUBMITTING CHANGE REQUEST:

SMJ METAL COMPANY INC.

	\$	-
	\$	-
	\$	-
TOTAL LUMP SUM SERVICES COST:		\$ -

5. SUBTOTAL OF SUBCONTRACTOR'S DIRECT COSTS (ITEMS 1, 2, 3, and 4)

\$ 1,089.16

6. SUBCONTRACTOR'S ALLOWED O&P MARK-UP ON ALLOWABLE DIRECT COSTS (10% OF ITEM 5)

10.00%

\$ 108.92

7. INSURANCE AND TAXES ON SUBCONTRACTOR BASE LABOR ONLY:

Total Base Wages Subject to Insurance and Taxes from Item 1 above \$ 809.16
Insurance & Taxes Rate (30%, or as approved on "RATE APPROVAL PRICING FORM") 30.00%

TOTAL COST INSURANCE AND TAXES ON LABOR \$ 242.75

8.

TOTAL COST OF WORK PERFORMED BY SUBCONTRACTOR (ITEMS 5, 6, and 7): \$ 1,440.82

9.

TOTAL COST OF WORK PERFORMED BY SUB-SUBCONTRACTOR(S) (Item 7 on attached Sub-Sub Form):

10.

** ALLOWABLE MARKUP ON SUB-SUBCONTRACTOR'S WORK (By Contract, 10% of Item 5 on attached Sub-Sub Form)

11.

TOTAL COST OF WORK INCLUDED IN THIS CHANGE REQUEST (ITEMS 9+10): \$ 1,440.82

12. SUBCONTRACTOR BOND

Approved bond premium percentage x item 11.

2.00% x ITEM 11:

\$ 28.82

13.

TOTAL CHANGE PROPOSAL AMOUNT, including bond cost \$ 1,470.00

Additional Notes:

Change proposals must include a cover letter on company letterhead identifying the PCI number, a description of the scope of work and the total cost of the Change Request.

** By Contract, the maximum aggregate mark-up allowed on direct allowable costs is 10%, and may be shared between Sub and Sub-Subs, where applicable.

AIA[®] Document G714[™] – 2007

Construction Change Directive

PROJECT: <i>(Name and address)</i> Caleb Dustin Hunking School 98 Winchester Street Haverhill, MA 01835	DIRECTIVE NUMBER: 013 DATE: February 18, 2016 CONTRACT FOR: General Construction	OWNER: <input type="checkbox"/> ARCHITECT: <input type="checkbox"/> CONSULTANT: <input type="checkbox"/> CONTRACTOR: <input type="checkbox"/> FIELD: <input type="checkbox"/> OTHER: <input type="checkbox"/>
TO CONTRACTOR: <i>(Name and address)</i> Shawmut Design & Construction 560 Harrison Avenue Boston, MA 02118	CONTRACT DATED: May 14, 2013 ARCHITECT'S PROJECT NUMBER: B130200.00	

You are hereby directed to make the following change(s) in this Contract:
(Describe briefly any proposed changes or list any attached information in the alternative)

Add steel beam per response to RFI 281, attached.

PROPOSED ADJUSTMENTS

1. The proposed basis of adjustment to the Contract Sum or Guaranteed Maximum Price is:

- ☐ • Lump Sum decrease of \$0.00
- ☐ • Unit Price of \$ per
- ☒ • As provided in Section 7.3.3 of AIA Document A201-2007
- ☐ • As follows:

2. The Contract Time is proposed to (remain unchanged). The proposed adjustment, if any, is 0 days.

When signed by the Owner and Architect and received by the Contractor, this document becomes effective IMMEDIATELY as a Construction Change Directive (CCD), and the Contractor shall proceed with the change(s) described above.

Contractor signature indicates agreement with the proposed adjustments in Contract Sum and Contract Time set forth in this CCD.

JCJ Architecture
ARCHITECT *(Firm name)*
One State Street, Suite 900
Boston, MA 02109
ADDRESS

City of Haverhill
OWNER *(Firm name)*
Four Summer Street, Room 100
Haverhill, MA 01830
ADDRESS

Shawmut Design & Construction
CONTRACTOR *(Firm name)*
560 Harrison Avenue
Boston, MA 02118
ADDRESS

BY *(Signature)*

Katy Lillich
(Typed name)

2.18.16
DATE

BY *(Signature)*

(Typed name)

DATE

BY *(Signature)*

(Typed name)

DATE



Request for Information RFI281

Project # 131411
MSBA - Haverhill Caleb Dustin MS

RFI #: RFI281

Date Created: February 10, 2016

To:

Katy Lillich
JCJ Architecture, Inc.
1 State Street
Boston MA, 02109

From:

Andrew LaRosa
Shawmut Design & Construction
560 Harrison Avenue
Boston MA, 02118

Subject

Sliding Glass Partition Beam

Source

Cost Impact

Potentially

Amount

\$TBD

Schedule Impact

Potentially

Days

TBD

Question

Date Required: February 17, 2016

Please see the attached marked up drawings for A-112 and S-122. Drawing A-112 shows the sliding glass partition extending to column line 12.1. Structural drawing S-122 shows W8x31 beams (beams that partition support attaches to) extending to column line 12, please confirm a W8x31 beam is necessary to be installed from column line 12 to 12.1.

Suggestion

Answer

Date Answered: ,

EDG GENERAL COMMENTS:

W8 steel beam is acceptable as proposed.

Reviewed by T.Cella-Mowatt 2/11/2016

Cc: Company Name

Contact Name

KKL 02/16/16

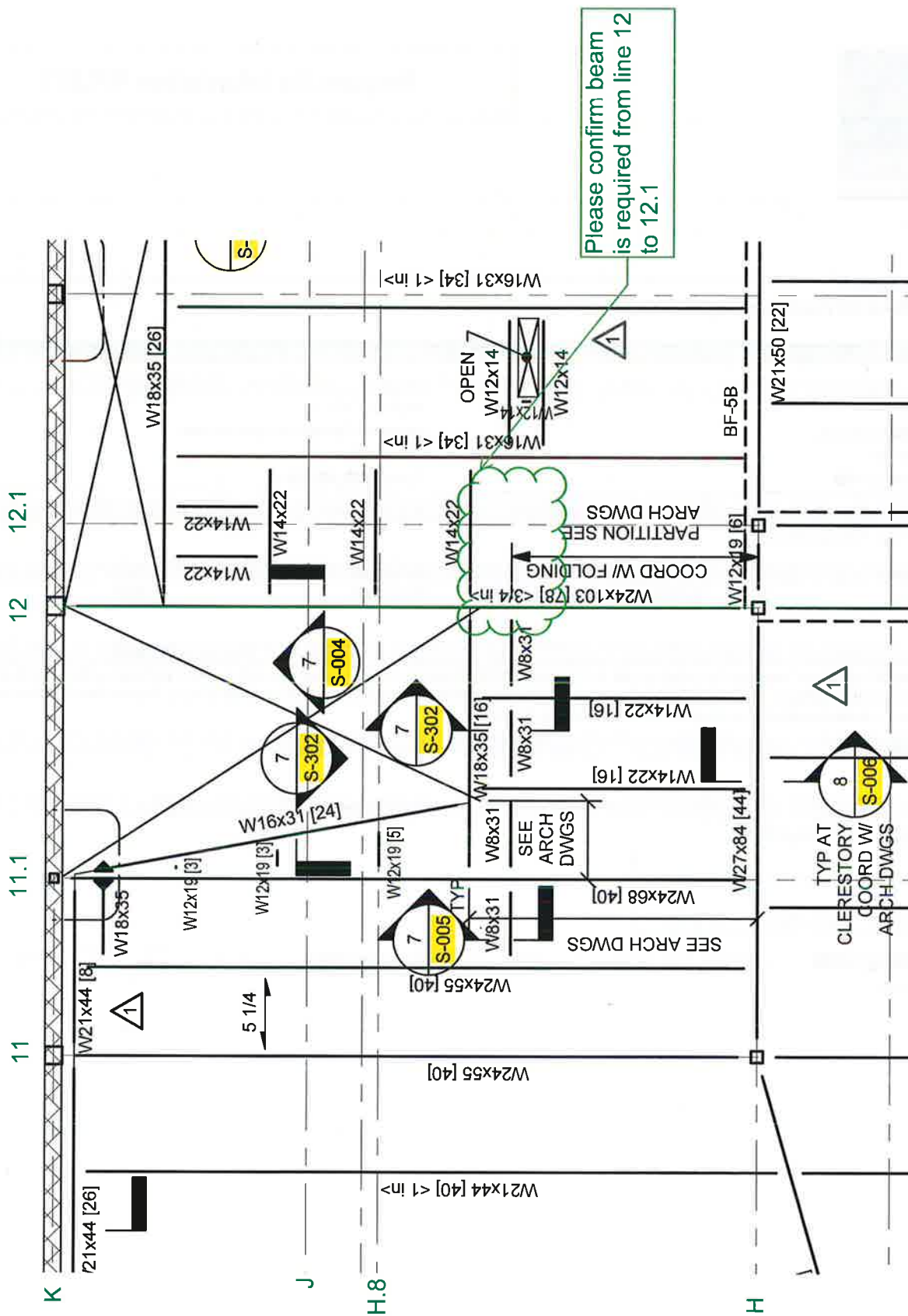

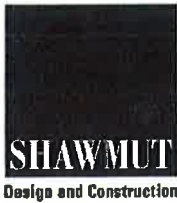

Change Request CR080

To: William Cunniff
Joslin Lesser & Assoc
44 Pleasant Street
Watertown, MA 02472

Date: March 3, 2016
Project #: 131411
Project: MSBA - Haverhill Caleb Dustin MS

Description: Add Floor Box at Project Area A315 per CCD-12

Item Description	Amount
Add Floor Box at Project Area A315 per CCD-12	\$2,487
Fee	\$102
GL Insurance	\$20
Builder's Risk	\$5
Bond	\$20
Total:	\$2,634

Type: Lump sum proposal
Schedule Impact: This change will add 0 day(s) to the contract completion date.
Overtime: Project OT Not Required
Notes:

By: Katy Lillich, JCJ Architecture, Inc.

3.15.16
Date:

By: Joseph Pollock, Shawmut Design & Construction

3/3/16
Date:

By: William Cunniff, Joslin Lesser & Assoc

3/16/16
Date:

CONSTRUCTION MANAGER CHANGE ORDER SUMMARY SHEET

PROJECT#: 131411 - Hunking School
CR#: CR 080
DESCRIPTION: Add Floor Box at Project Area A315 per CCD-12
DATE: 03/03/16
REFERENCE: CCD-12
CONSTRUCTION MANAGER: Shawmut Design and Construction

SECTION I - SUBCONTRACTORS

	Direct Costs	Non-Direct Costs	Total Costs
Levangie Electric	\$ 2,049.04	\$ 437.96	\$ 2,487
			\$ -
			\$ -
			\$ -
			\$ -
			\$ -
			\$ -
TOTALS	\$ 2,049.04	\$ 437.96	\$ 2,487.00

SECTION II - CM MARK-UPS

			Total Costs
Subcontract Direct Costs		\$ 2,049.04	
CM Fee on Direct Costs Only	5.00%	\$ 102.00	
Subcontract Non-Direct Costs		\$ 437.96	
			\$ 2,589
General Liability Insurance	0.76%	\$ 20.00	
Builder's Risk	0.18%	\$ 5.00	
			\$ 2,614
Payment and Performance Bond	0.75%	\$ 20.00	
TOTAL CHANGE ORDER AMOUNT:			\$ 2,634

CRO80

LEVANGIE ELECTRIC CO. INC.

59 OLD WEBSTER ST.
HANOVER, MA. 02339
Phone 781 792-4900 ext 311
Fax 781 871-2891

February 24, 2016

SHAWMUT DESIGN & CONSTRUCTION
560 HARRISON AVE.
BOSTON, MA. 02118
ATTN: ROBERT JOUBERT

RE: CALEB DUSTIN HUNKING SCHOOL
SUBJECT: CCD#12

Dear Robert,

As per your request, we herewith submit our quote in the amount listed below for electric changes detailed in the above referenced CCD#12.

MATERIALS				\$	934.07
				\$	-
BASE RATE	\$	47.08 /HR	X	14.76 /HR	\$ 694.90
HEALTH & PENSION	\$	28.46 /HR	X	14.76 /HR	\$ 420.07
SUBTOTAL				\$	2,049.04
OVERHEAD/ PROFIT		10%		\$	204.90
LABOR BURDEN		30%		\$	208.47
SUBTOTAL				\$	2,462.41
BOND PREMIUM		1.00%		\$	24.62
TOTAL THIS CHANGE				\$	2,487.00

Please issue a written change order if we are to proceed with this change. **Note this price is good for 30days and void if ceilings are installed before approval.**

Sincerely,



John P. O'Neil

Lower-tier Subs, Use SUB-
SUBCONTRACTOR Form, NOT this form.

Caleb Dustin Hunking School	PROJ. NO.	C.M.	Shawmut Design & Construction
SDC PCI NUMBER:	PCI DESC.		
DATE:	CCD #12		
FIRM SUBMITTING CHANGE REQUEST:			
LeVangie Electric Co., Inc.			

Use only Prevailing Wage Rates or Owner-Approved Wages and Rates

If any work is performed by a lower tier sub, labor rates must be approved by the Owner prior to executing any change, and those costs presented on a Sub Subcontractor Change Request Form

Trade	Classification (Foreman, Journeyman, Apprentice)	Total Hrs. Worked	These values shall be taken from the "REQUEST FOR APPROVAL FOR CHANGE ORDER PRICING" form, after its approval by the CM and Owner				Total Direct Labor Cost
			Total Hourly Labor Costs (Item 1 from Wage Approval Sheet)	Total Base Cost + Fringe	Wages from Wage Approval Sheet)	Base Wage Rate for Ins/Taxes (Item D from Wage Approval Sheet)	
Electrical	Journeyman	14.76	\$ 47.08	\$ 694.90	\$ 28.46	\$ 694.90	
				\$ -		\$ -	
				\$ -		\$ -	
				\$ -		\$ -	
				\$ -		\$ -	
				Total Base Wages	\$ 420.07	\$ 420.07	
TOTAL BASE and FRINGE DIRECT LABOR COSTS						\$ 1,114.97	

(For extensive material lists, attach detailed backup and enter as a lump sum below)

Material Description	Qty	Unit	Cost Per Unit	Total
MATERIALS	1.00		\$934.07	\$ 934.07
				\$
				\$
				\$
				\$
				\$
				\$
				\$
TOTAL MATERIALS COST:			\$	\$ 934.07

(For extensive equipment lists, attach detailed backup and enter as a turn sum below)

Equipment Description	QTY	Unit	Cost Per Unit	Total
				\$
				\$
				\$
				\$
				\$
TOTAL EQUIPMENT COST:				\$

SDC PCI NUMBER:
DATE:

PCI DESC: CD#12

FIRM SUBMITTING CHANGE REQUEST:

LeVangie Electric Co., Inc.

4. LUMP SUM SERVICES PROVIDED TO SUBCONTRACTOR (Not Typical. Contact GC for Direction):

Description of Lump Sum Service - attach backup	Total
	\$ -
	\$ -
	\$ -
	\$ -
TOTAL LUMP SUM SERVICES COST:	\$ -

5. SUBTOTAL OF SUBCONTRACTOR'S DIRECT COSTS (ITEMS 1, 2, 3, and 4)

\$ 2,049,014

6. SUBCONTRACTOR'S ALLOWED O&P MARK-UP ON ALLOWABLE DIRECT COSTS (10% OF ITEM 5)

10.00%
\$ 204,901

7. INSURANCE AND TAXES ON SUBCONTRACTOR BASE LABOR ONLY:

Total Base Wages Subject to Insurance and Taxes from Item 1 above: \$ 694,901
Insurance & Taxes Rate (1.2%), or as approved on "REQUEST FOR APPROVAL FOR CHANGE ORDER PRICING" form 1: 30.00%

TOTAL COST INSURANCE AND TAXES ON LABOR

\$ 208,471

8.

TOTAL COST OF WORK PERFORMED BY SUBCONTRACTOR (ITEMS 5, 6, and 7): \$ 2,462,411

9.

TOTAL COST OF WORK PERFORMED BY SUB-SUBCONTRACTOR(S) (Item 7 on attached Sub-Sub Form):

10.

** ALLOWABLE MARKUP ON SUB-SUBCONTRACTOR'S WORK (By Contract, 10% of Item 5 on attached Sub-Sub Form)

11.

TOTAL COST OF WORK INCLUDED IN THIS CHANGE REQUEST (ITEMS 9+10): \$ 2,462,411

12. SUBCONTRACTOR BOND

Approved bond premium percentage X item 11

1.00% X ITEM 11: \$ 24,624

13.

TOTAL CHANGE PROPOSAL AMOUNT, including bond cost \$ 2,487,000

Additional Notes:

Change proposals must include a cover letter on company letterhead identifying the PCI number, a description of the scope of work and the total cost of the Change Request.

** By Contract, the maximum aggregate mark-up allowed on direct allowable costs is 10%, and may be shared between Sub and Sub-Subs, where applicable.

Job Name: Caleb Dustin Hunking School

Column 1	Column 2	Column 3	Column 4	Column 5
CCD#12	base bid	base bid	Combined	ALL

Items+ByProducts

Item #	Item Name	QUANTITY	Mtl Price	MAT. EXT.	Labor	LABOR EXT.
Category: Cost Code <none>						
6,837	AS BUILT DRAWINGS	0.10	\$16.00	\$1.60	1.000	0.10
Totals for Cost Cod				<u>\$1.60</u>		<u>0.10</u>
Category: Cost Code FEEDER RACEWAY						
5,334	.CORE DRILL	1.00	\$30.30 E	\$30.30	2.250 E	2.25
Totals for Cost Cod				<u>\$30.30</u>		<u>2.25</u>
Category: Cost Code DEVICES & PLATES						
60,023	QUAD POKE THRU	1.00	\$462.00	\$462.00	2.000	2.00
Totals for Cost Cod				<u>\$462.00</u>		<u>2.00</u>
Category: Cost Code TEL/TV/CATV OUTLETS						
5,540	CAT 6A JACK	4.00	\$11.10 E	\$44.40	0.280 E	1.12
5,554	LABEL JACK/CABLE	4.00	\$1.50	\$6.00	0.200	0.80
5,555	TEST DEVICE/CABLE	4.00	\$1.20	\$4.80	0.250	1.00
5,556	CABLE PUNCH DOWN	4.00	\$8.00	\$32.00	0.150	0.60
5,558	7' cat 6a patch cord	4.00	\$16.00	\$64.00	0.100	0.40
5,562	CAT 6 AUGMENTED NP	478.24	\$0.38 E	\$179.34	0.007 E	3.35
5,621	CAT 6A 48 PORT PATC	0.10	\$364.00	\$36.40	6.000	0.60
Totals for Cost Cod				<u>\$366.94</u>		<u>7.87</u>
Category: Cost Code WIRE						
294	12/2 MC CABLE W/G	122.01	\$0.60	\$73.23	0.013	1.54
Totals for Cost Cod				<u>\$73.23</u>		<u>1.54</u>
Category: Cost Code MISC.						
6,840	CLEAN UP HOUR	0.60	\$0.00	\$0.00	1.000	0.60
6,845	ONSITE TRADE COOR	0.40	\$0.00	\$0.00	1.000	0.40
Totals for Cost Cod				<u>\$0.00</u>		<u>1.00</u>
Totals:				<u>\$934.07</u>		<u>14.76</u>



AIA Document G714™ – 2007

Construction Change Directive

PROJECT: (Name and address)

Caleb Dustin Hunking School
98 Winchester Street
Haverhill, MA 01835

DIRECTIVE NUMBER: 012

DATE: February 17, 2016

CONTRACT FOR: General Construction

OWNER: ☐
ARCHITECT: ☐
CONSULTANT: ☐
CONTRACTOR: ☐
FIELD: ☐
OTHER: ☐
TO CONTRACTOR: (Name and address)

Shawmut Design & Construction
560 Harrison Avenue
Boston, MA 02118

CONTRACT DATED: May 14, 2013

ARCHITECT'S PROJECT NUMBER:
B130200.00

You are hereby directed to make the following change(s) in this Contract:
(Describe briefly any proposed changes or list any attached information in the alternative)

At the direction of the owner, add floor box as described in SK-037 and SKE-15, attached .

PROPOSED ADJUSTMENTS

1. The proposed basis of adjustment to the Contract Sum or Guaranteed Maximum Price is:

☐ • Lump Sum decrease of \$0.00

☐ • Unit Price of \$ per

☒ • As provided in Section 7.3.3 of AIA Document A201-2007

☐ • As follows:

2. The Contract Time is proposed to (remain unchanged). The proposed adjustment, if any, is 0 days.

When signed by the Owner and Architect and received by the Contractor, this document becomes effective IMMEDIATELY as a Construction Change Directive (CCD), and the Contractor shall proceed with the change(s) described above.

Contractor signature indicates agreement with the proposed adjustments in Contract Sum and Contract Time set forth in this CCD.

JCJ Architecture
ARCHITECT (Firm name)

One State Street, Suite 900
Boston, MA 02109

ADDRESS
BY (Signature)
Katy Lillich
(Typed name)
DATE
City of Haverhill
OWNER (Firm name)

Four Summer Street, Room 100
Haverhill, MA 01830

ADDRESS
BY (Signature)
(Typed name)
DATE
Shawmut Design & Construction
CONTRACTOR (Firm name)

560 Harrison Avenue
Boston, MA 02118

ADDRESS
BY (Signature)
(Typed name)
DATE

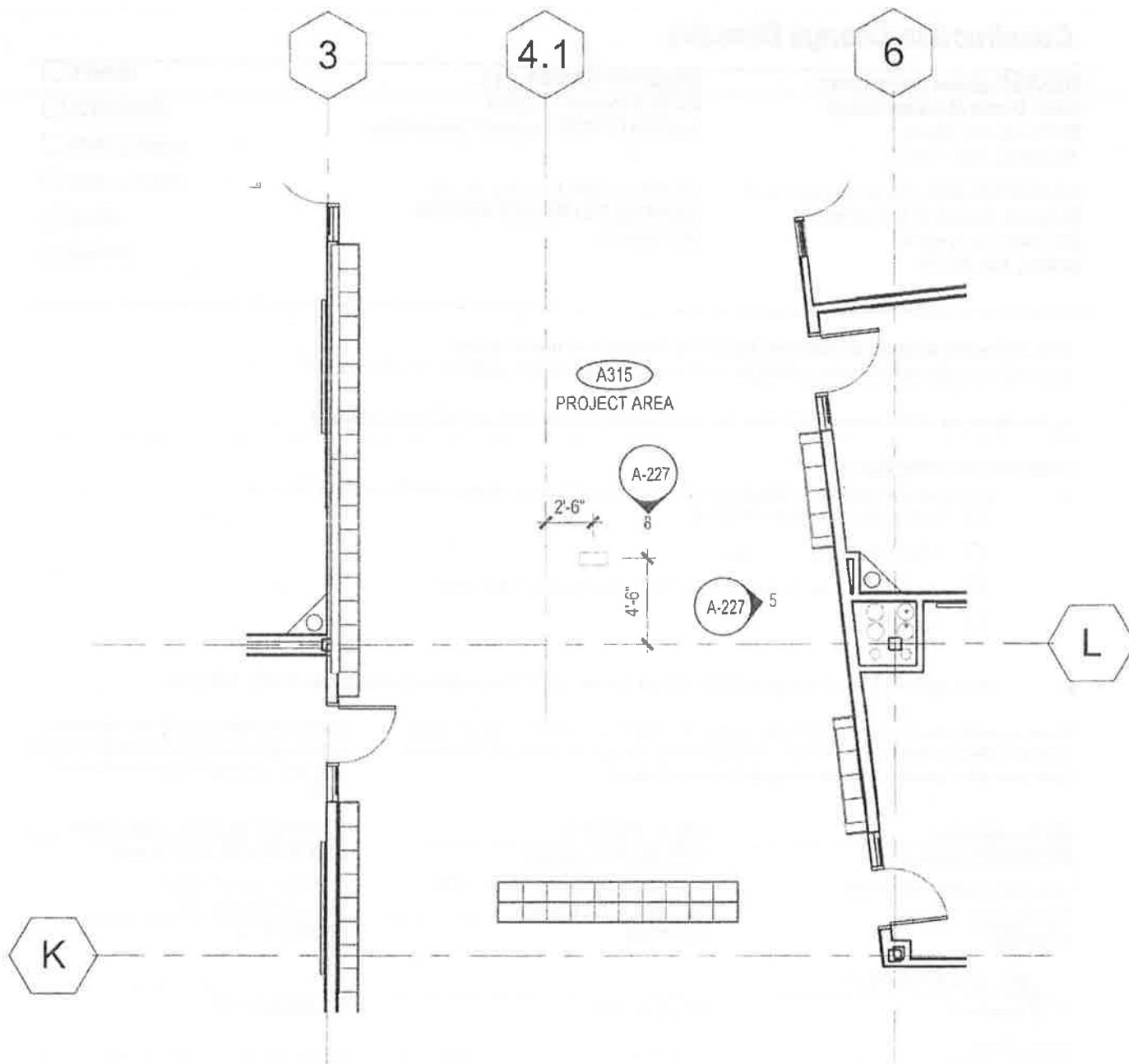

1 PROJECT AREA A315 - FLOOR BOX

1/8" = 1'-0"

JCJARCHITECTURE

38 PROSPECT STREET
HARTFORD CT 06103
860 247 9226

PROJECT ROOM A315 - FLOOR BOX
LOCATION

CALEB DUSTIN HUNKING SCHOOL

DRAWING REFERENCE:

DATE: 02/11/16

PROJECT: B13020.01

DRAWN: EEC

SCALE: 1/8" = 1'-0"

SK-037

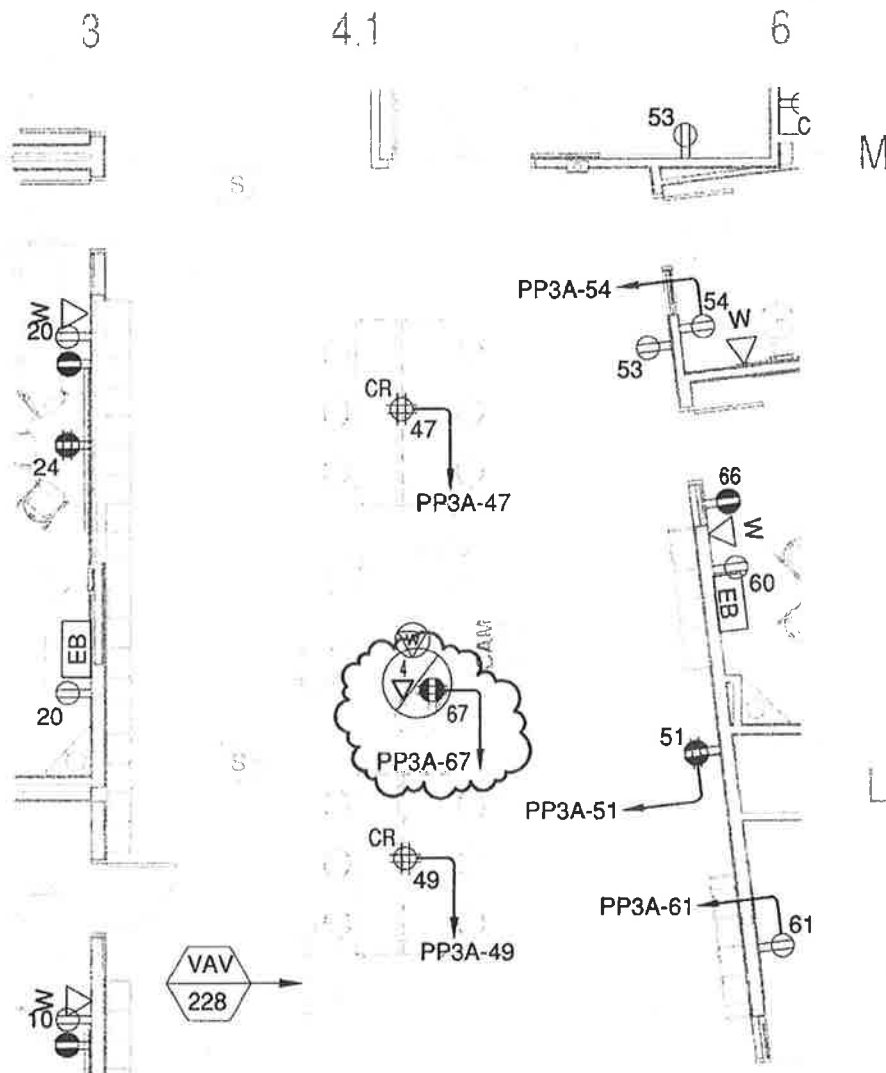

1 Partial THIRD FLOOR AREA A - POWER PLAN
SKE-15 SCALE: 1/8" = 1'-0"

NOTES:

1. E.C. TO UTILIZE EXISTING SPARE 20A-1P SPARE CIRCUIT BREAKER IN PANEL PP3A.
2. 4 DATA INDICATED IN NEW POKE-THRU DEVICE FOR REFERENCE ONLY, EXACT DATA &/OR VIDEO REQUIREMENTS TO BE COORDINATED WITH OWNER'S IT CONSULTANT.

JCJ ARCHITECTURE

38 PROSPECT STREET
HARTFORD, CT 06103
860.247.9226

**ADDED POKE-THRU DEVICE @ PROJECT
AREA A315**

CALEB DUSTIN HUNKING SCHOOL

DRAWING REFERENCE: E-231

DATE: 02/17/16

PROJECT: B13020.01

DRAWN: MB

SCALE: 1/8" = 1'-0"

SKE-15

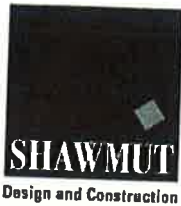

Change Request CR083

To: William Cunniff
Joslin Lesser & Assoc
44 Pleasant Street
Watertown, MA 02472

Date: March 3, 2016
Project #: 131411
Project: MSBA - Haverhill Caleb Dustin MS

Description: Add Soffit in Art Room A227 to Conceal Deep Beam & Gas Line per RFI #292

Item Description

	Amount
Add Soffit in Art Room A227 to Conceal Deep Beam & Gas Line per RFI #292	
Fee	\$2,556
GL Insurance	\$99
Builder's Risk	\$20
Bond	\$5
	\$20
Total:	\$2,700

Type: Lump sum proposal
Schedule Impact: This change will add 0 day(s) to the contract completion date.
Overtime: Project OT Not Required
Notes:

By: Katy Lillich, JCJ Architecture, Inc.

3.15.16
Date:

By: Joseph Pollock, Shawmut Design & Construction

3/3/16
Date:

By: William Cunniff, Joslin Lesser & Assoc

3/16/16
Date:

SECTION II - CM MARK-UPS			Total Costs
Subcontract Direct Costs		\$ 1,987.51	
CM Fee on Direct Costs Only	5.00%	\$ 99.00	
Subcontract Non-Direct Costs		\$ 568.49	
			\$ 2,655
General Liability Insurance	0.76%	\$ 20.00	
Builder's Risk	0.18%	\$ 5.00	
			\$ 2,680
Payment and Performance Bond	0.75%	\$ 20.00	
TOTAL CHANGE ORDER AMOUNT:			\$ 2,700

SUBCONTRACTOR CHANGE REQUEST

Caleb Dustin Hunking School		PROJ. NO.	131411	C.M. Shawmut Design & Construction
SDC PCI NUMBER:	RFI-292	PCI DESC.	Add Soffit in Art Room A227 to Conceal Deep Beam & Gas Line per RFI #292	
DATE:	3/2/2016			
FIRM SUBMITTING CHANGE REQUEST:				
Angelini Plastering Inc				

1. DIRECT LABOR: SUBCONTRACTOR and/or SUB-SUBCONTRACTOR:

Use only Prevailing Wage Rates or Owner-Approved Wages and Rates
If any work is performed by a lower tier sub, labor rates must be approved by the Owner prior to executing any changes, and those costs presented on a Sub-Subcontractor Change Request Form.

Trade	Classification (Foreman, Journeyman, Apprentice)	Total Hrs. Worked	These values shall be taken from the "Rate Approval Pricing Form", after its approval by the CM and Owner or the Prevailing Wage Table in the specifications.			Total Labor Cost (Wages + Fringe only)
			Hourly Labor Rate (Base + Fringes); (Item 1 from Rate Approval Pricing Form OR Total Rate from PREVAILING WAGE RATE TABLE)	Total Labor Cost (Wages + Fringe only)	Base Wage Rate for Ins/Taxes (Item D from Rate Approval Pricing Form, or Base Rate from PREVAILING WAGE RATE TABLE)	
Carpenter	Foreman-MacLean	2.00	\$ 75.81	\$ 151.62	\$ 48.11	\$ 151.62
Carpenter	Journeyman-API	16.00	\$ 70.81	\$ 1,132.96	\$ 43.11	\$ 1,132.96
Taper	Foreman-Strout		\$ 72.37	\$ -	\$ 44.95	\$ -
Taper	Journeyman-API	6.00	\$ 69.87	\$ 419.22	\$ 42.45	\$ 419.22
Laborer	Foreman-Delaney	3.00	\$ 57.25	\$ 171.75	\$ 35.35	\$ 171.75
			Total Base Wages	\$ 1,146.73		
			TOTAL BASE and FRINGE DIRECT LABOR COSTS			\$ 1,875.55

2. MATERIALS: SUBCONTRACTOR:

(For extensive material lists, attach detailed backup and enter as a lump sum below)

Material Description		Qty	Unit	Cost Per Unit	Total
3 5/8" track		82.00	LF	\$0.43	\$ 35.26
3 5/8" Stud		62.00	LF	\$0.45	\$ 27.90
Type X drywall		86.00	SQFT	\$0.30	\$ 25.80
Drywall compound		86.00	SQFT	\$0.10	\$ 8.60
Fasteners		288.00	PCS	\$ 0.05	\$ 14.40
				\$ -	\$ -
				\$ -	\$ -
TOTAL MATERIALS COST:				\$	111.96

3. EQUIPMENT: SUBCONTRACTOR:

(For extensive equipment lists, attach detailed backup and enter as a lump sum below)

Equipment Description	Qty	Unit	Cost Per Unit	Total	
			\$ -	\$ -	
			\$ -	\$ -	
			\$ -	\$ -	
			\$ -	\$ -	
			TOTAL EQUIPMENT COST:		\$ -

SDC PCI NUMBER: RFI-292
DATE: 3/2/2016

PCI DESC: Add fire caulking at the 2 nd floor top and bottom and at 1st floor top and third floor top

4. LUMP SUM SERVICES PROVIDED TO SUBCONTRACTOR (Not Typical. Contact GC for Direction):

Description of Lump Sum Service - attach backup	Total
	\$ -
	\$ -
	\$ -
	\$ -
	\$ -
TOTAL LUMP SUM SERVICES COST:	\$ -

5. SUBTOTAL OF SUBCONTRACTOR'S DIRECT COSTS (ITEMS 1, 2, 3, and 4)

\$ 1,987.51

6. SUBCONTRACTOR'S ALLOWED O&P MARK-UP ON ALLOWABLE DIRECT COSTS (10% OF ITEM 5)

\$ 198.75

7. INSURANCE AND TAXES ON SUBCONTRACTOR BASE LABOR ONLY:

Total Base Wages Subject to Insurance and Taxes from Item 1 above \$ 1,146.73
Insurance & Taxes Rate (30%, or as approved on "RATE APPROVAL PRICING FORM") 30.00%

TOTAL COST INSURANCE AND TAXES ON LABOR \$ 344.02

8.

TOTAL COST OF WORK PERFORMED BY SUBCONTRACTOR (ITEMS 5, 6, and 7): \$ 2,530.28

9.

TOTAL COST OF WORK PERFORMED BY SUB-SUBCONTRACTOR(S) (Item 7 on attached Sub-Sub Form):

10.

**** ALLOWABLE MARKUP ON SUB-SUBCONTRACTOR'S WORK** (By Contract, 10% of Item 5 on attached Sub-Sub Form)

11.

TOTAL COST OF WORK INCLUDED IN THIS CHANGE REQUEST (ITEMS 9+10): \$ 2,530.28

12. SUBCONTRACTOR BOND

Approved bond premium percentage x item 11:

1.00% x ITEM 11: \$ 25.30

13.

TOTAL CHANGE PROPOSAL AMOUNT, including bond cost \$ 2,556.00

Additional Notes:

Change proposals must include a cover letter on company letterhead identifying the PCI number, a description of the scope of work and the total cost of the Change Request.
** By Contract, the maximum aggregate mark-up allowed on direct allowable costs is 10%, and may be shared between Sub and Sub-Subs, where applicable.

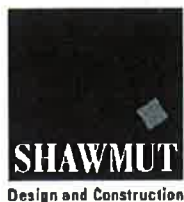

Request for Information RFI292

Project # 131411
MSBA - Haverhill Caleb Dustin MS

RFI #: RFI292

Date Created: February 19, 2016

To:

Katy Lillich
JCJ Architecture, Inc.
1 State Street
Boston MA, 02109

From:

Andrew LaRosa
Shawmut Design & Construction
560 Harrison Avenue
Boston MA, 02118

Subject

Art Room A227 Gas Line

Source

Cost Impact

Potentially

Amount

\$TBD

Schedule Impact

Potentially

Days

TBD

Question

Date Required: February 26, 2016

Room A227 has a 40" deep beam at column line 9 putting the bottom of the beam at approximately 9' above the floor. The ceiling in this area of the room is at 9'-4", there is also a 3" gas line that comes into this room through the masonry wall at column line 10 and feeds RTU #9. To cover up the steel in this area and also the gas line that feeds RTU #9 we are proposing a soffit in the area of this room that has a ceiling. The bottom of the soffit would be 5" below the beam and the side of it would be 5" south of the beam, the soffit would return up at the west edge of the ceiling. Please confirm this is acceptable.

Suggestion

Answer

Date Answered:

Per discussion on site, this is acceptable.
KKL 02/22/16

Cc: Company Name

Contact Name

9
10

proposed soffit

4" CELL
EXPANSION
JOINT

ACP-1
9'-4^{HF}

9-4

A227

 $\frac{1}{2}$

RC1

刀

5

 $B=7 \cdot 10^{-7}$

6:11-5"

 $B=7'$

↑
TOKYO

9

E: 20'-0"

1 1/2"

Up 1 1/2"

1000

26x16

1

49x23

Up 1 1/2"

1/2"

$T = 10^\circ \text{C}$

—

[illegible]

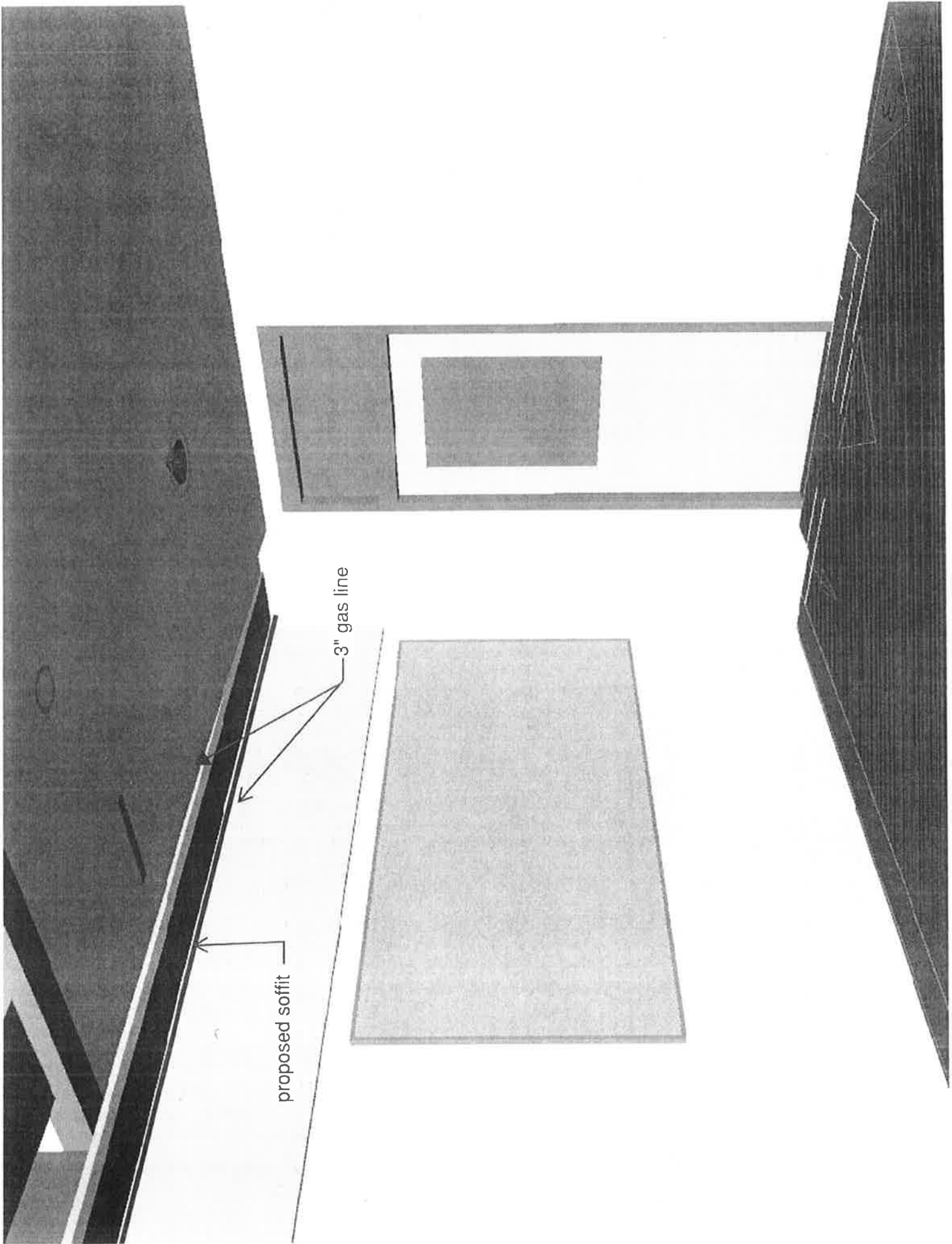



Change Request CR087

To: William Cunniff
Joslin Lesser & Assoc
44 Pleasant Street
Watertown, MA 02472

Date: March 14, 2016
Project #: 131411
Project: MSBA - Haverhill Caleb Dustin MS

Description: Add Tectum Panels in Seven Rooms per PR 019R

Item Description	Amount
Add Tectum Panels in Seven Rooms per PR 019R	\$91,977
Fee	\$4,139
GL Insurance	\$730
Builder's Risk	\$173
Bond	\$728
Total:	\$97,747

Type: Lump sum proposal
Schedule Impact: This change will add 0 day(s) to the contract completion date.
Overtime: Project OT Not Required
Notes: Please note this pricing does not include any cost for painting of the tectum panels or MEP relocations.

By: Katy Lillich, JCJ Architecture, Inc.

Date: 3-15-16

By: Joseph Pollock, Shawmut Design & Construction

Date: 3/14/16

By: William Cunniff, Joslin Lesser & Assoc

Date: 3/16/16

CONSTRUCTION MANAGER CHANGE ORDER SUMMARY SHEET

PROJECT#: 131411 - Hunking School
CR#: 087

DESCRIPTION: Add Tectum Panels in Seven Rooms per PR-019R

DATE: 03/14/16
REFERENCE: PR-019R
CONSTRUCTION MANAGER: Shawmut Design and Construction

SECTION I - SUBCONTRACTORS		Direct Costs	Non-Direct Costs	Total Costs
K&K Acoustical Ceilings		\$ 82,787.00	\$ 9,189.56	\$ 91,977
				\$ -
				\$ -
				\$ -
				\$ -
				\$ -
				\$ -
				\$ -
TOTALS		\$ 82,787.00	\$ 9,189.56	\$ 91,977.00

SECTION II - CM MARK-UPS			Total Costs
Subcontract Direct Costs		\$ 82,787.00	
CM Fee on Direct Costs Only	5.00%	\$ 4,139.00	
Subcontract Non-Direct Costs		\$ 9,189.56	
			\$ 96,116
General Liability Insurance	0.76%	\$ 730.00	
Builder's Risk	0.18%	\$ 173.00	
			\$ 97,019
Payment and Performance Bond	0.75%	\$ 728.00	
TOTAL CHANGE ORDER AMOUNT:			\$ 97,747

K & K ACOUSTICAL CEILINGS, INC.

March 14, 2016

Shawmut Design and Construction
560 Harrison Avenue
Boston, MA 02118

Attn: Joseph Pollock

Reference: Caleb Dustin Hunking School – PR-19R

- 6,600 square feet of Tectum Finale 2x6 in White

Price \$91,977.00

Sincerely,



Kevin Kontos Jr.

SUBCONTRACTOR CHANGE REQUESTLower-tier Subs, Use SUB-
SUBCONTRACTOR Form, NOT this form

SDC PCI NUMBER: PR-19R	PROJ. NO. 	C.M. Shawmut Design & Construction
DATE: 3/14/2016	PCI DESC. 	
FIRM SUBMITTING CHANGE REQUEST: K&K Acoustical Ceilings, Inc.		

1. DIRECT LABOR: SUBCONTRACTOR and/or SUB-SUBCONTRACTOR:

Use only Prevailing Wage Rates or Owner-Approved Wages and Rates

If any work is performed by a lower tier sub, labor rates must be approved by the Owner prior to executing any changes, and those costs presented on a Sub-Subcontractor Change Request Form.

Trade	Classification (Foreman, Journeyman, Apprentice)	Total Hrs. Worked	These values shall be taken from the "REQUEST FOR APPROVAL FOR CHANGE ORDER PRICING" form, after its approval by the CM and Owner			Total Direct Labor Cost
			Total Hourly Labor Costs (Item I from Wage Approval Sheet)	Total Base Cost + Fringe	Base Wage Rate for Ins/Taxes (Item D from Wage Approval Sheet)	
Carpenter	Foreman	376.00	\$ 64.94	\$ 24,417.44	\$ 40.10	\$ 24,417.44
				\$ -		\$ -
				\$ -		\$ -
				\$ -		\$ -
				\$ -		\$ -
				Total Base Wages	\$ 9,180,957.44	
TOTAL BASE and FRINGE DIRECT LABOR COSTS						\$ 24,417.44

2. MATERIALS: SUBCONTRACTOR:

(For extensive material lists, attach detailed backup and enter as a lump sum below)

Material Description	Qty	Unit	Cost Per Unit	Total
Techum Finale	6,600.00	S/F	\$7.68	\$ 50,688.00
Furring & Suspension	6,600.00	Lin/Ft	\$0.97	\$ 6,402.00
				\$ -
				\$ -
				\$ -
				\$ -
TOTAL MATERIALS COST				\$ 57,090.00

3. EQUIPMENT: SUBCONTRACTOR:

(For extensive equipment lists, attach detailed backup and enter as a lump sum below)

Equipment Description	Qty	Unit	Cost Per Unit	Total
Lin	1.00		\$ 1,280.00	\$ 1,280.00
				\$ -
				\$ -
				\$ -
TOTAL EQUIPMENT COST:				\$ 1,280.00

SDC PCI NUMBER: PR-19R
DATE: 3/14/2016

PCI DESC:

FIRM SUBMITTING CHANGE REQUEST: K&K Acoustical Ceilings, Inc.

4. LUMP SUM SERVICES PROVIDED TO SUBCONTRACTOR (Not Typical. Contact GC for Direction):

Description of Lump Sum Service - attach backup	Total
	\$ -
	\$ -
	\$ -
	\$ -
TOTAL LUMP SUM SERVICES COST:	\$ -

5. SUBTOTAL OF SUBCONTRACTOR'S DIRECT COSTS (ITEMS 1, 2, 3, and 4)

\$ 82,787.44

6. SUBCONTRACTOR'S ALLOWED O&P MARK-UP ON ALLOWABLE DIRECT COSTS (10% OF ITEM 5)

10.00%

\$ 8,278.74

7. INSURANCE AND TAXES ON SUBCONTRACTOR BASE LABOR ONLY:

Total Base Wages Subject to Insurance and Taxes from Item 1 above: \$ 9,180,957.44

Insurance & Taxes Rate (30%, or as approved on "REQUEST FOR APPROVAL FOR CHANGE ORDER PRICING" form)

TOTAL COST INSURANCE AND TAXES ON LABOR \$ -

8. TOTAL COST OF WORK PERFORMED BY SUBCONTRACTOR (ITEMS 5, 6, and 7): \$ 91,066.18

9. TOTAL COST OF WORK PERFORMED BY SUB-SUBCONTRACTOR(S) (Item 7 on attached Sub-Sub Form):

10. ** ALLOWABLE MARKUP ON SUB-SUBCONTRACTOR'S WORK (By Contract, 10% of Item 5 on attached Sub-Sub Form) 10%

11. TOTAL COST OF WORK INCLUDED IN THIS CHANGE REQUEST (ITEMS 9+10): \$ 91,066.28

12. SUBCONTRACTOR BOND

Approved bond premium percentage x item 11.

1.00% x ITEM 11:

\$ 910.66

13. TOTAL CHANGE PROPOSAL AMOUNT, including bond cost: \$ 91,977.00

Additional Notes:

Change proposals must include a cover letter on company letterhead identifying the PCI number, a description of the scope of work and the total cost of the Change Request.

** By Contract, the maximum aggregate mark-up allowed on direct allowable costs is 10%, and may be shared between Sub and Sub-Subs, where applicable.



AIA[®] Document G709[™] – 2001

Work Changes Proposal Request

PROJECT *(Name and address):*
Caleb Dustin Hunking School
98 Winchester Street
Haverhill, MA 01835

PROPOSAL REQUEST NUMBER: 019R

DATE OF ISSUANCE: 02/25/2016

OWNER: ☐

ARCHITECT: ☐

CONSULTANT: ☐

CONTRACTOR: ☐

FIELD: ☐

OTHER: ☐

OWNER *(Name and address):*
City of Haverhill
Four Summer Street, Room 100
Haverhill, MA 01830

CONTRACT FOR: General Construction

CONTRACT DATE: May 14, 2013

FROM ARCHITECT *(Name and address):*

JCJ Architecture
One State Street, Suite 900
Boston, MA 02109

ARCHITECT'S PROJECT NUMBER:
B130200.00

TO CONTRACTOR *(Name and address):*

Shawmut Design & Construction
560 Harrison Avenue
Boston, MA 02118

Please submit an itemized proposal for changes in the Contract Sum and Contract Time for proposed modifications to the Contract Documents described herein. Within Zero (0) days, the Contractor must submit this proposal or notify the Architect, in writing, of the date on which proposal submission is anticipated.

THIS IS NOT A CHANGE ORDER, A CONSTRUCTION CHANGE DIRECTIVE OR A DIRECTION TO PROCEED WITH THE WORK DESCRIBED IN THE PROPOSED MODIFICATIONS.

DESCRIPTION *(Insert a written description of the Work):*

Provide cost for addition of Tectum Finale 1" panels, 24" wide in rooms A105, A112, A205, A212, B229, C234 and A305.

ATTACHMENTS *(List attached documents that support description):*

SKA-039, SKA-040 and SKA-041.

REQUESTED BY THE ARCHITECT:

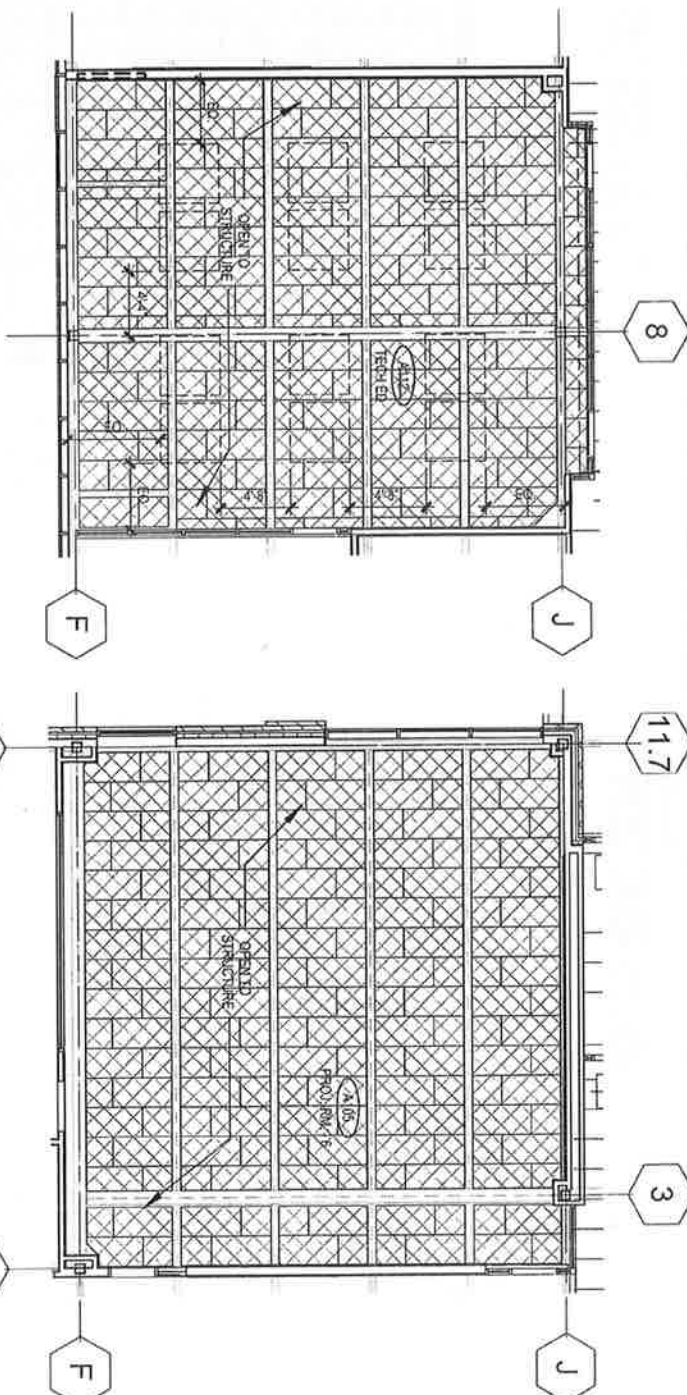

(Signature)

Katy Lillich
(Printed name and title)

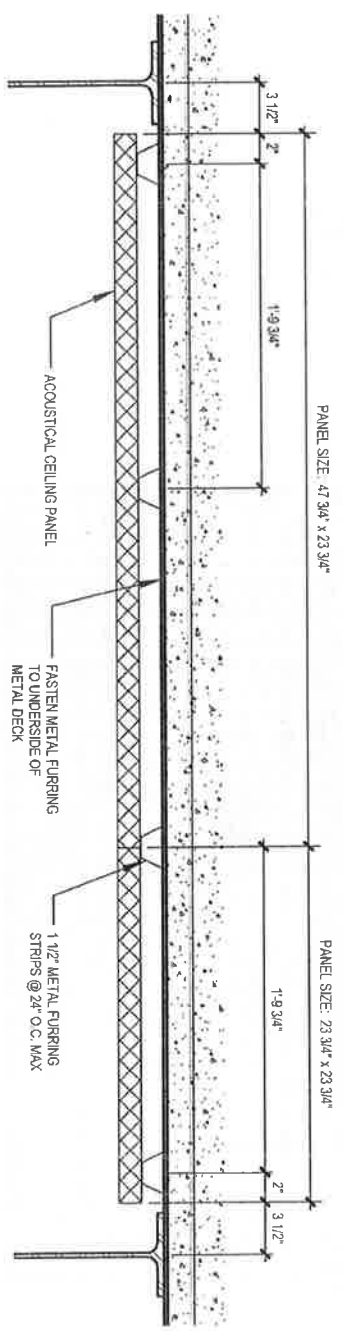

3
A112 - TECH ED RCP
1/8" = 1'-0"

2
A105 - PROJECT ROOM RCP
1/8" = 1'-0"



1
ACOUSTIC PANEL CONNECTION
1 1/2\"/>

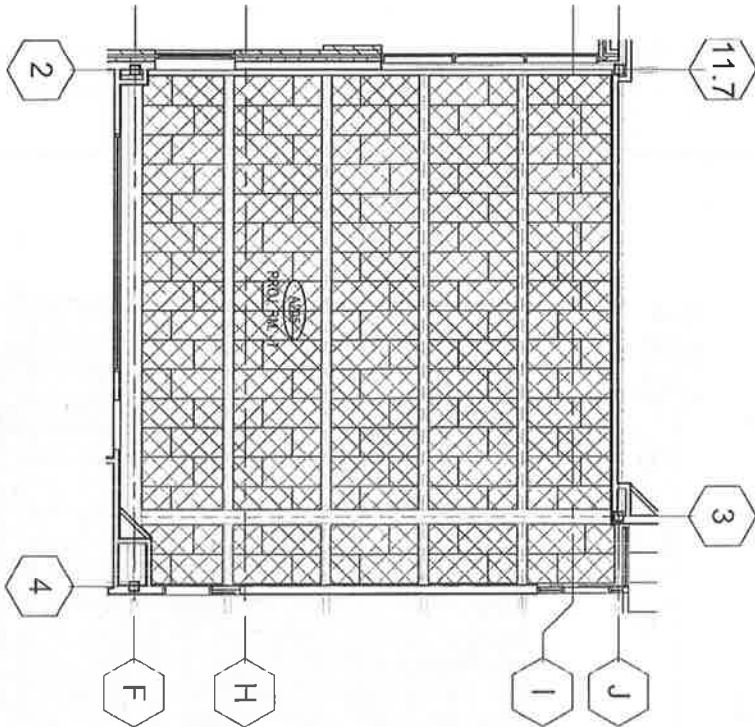

3 A205 - PROJECT ROOM RCP
1/8" = 1'-0"

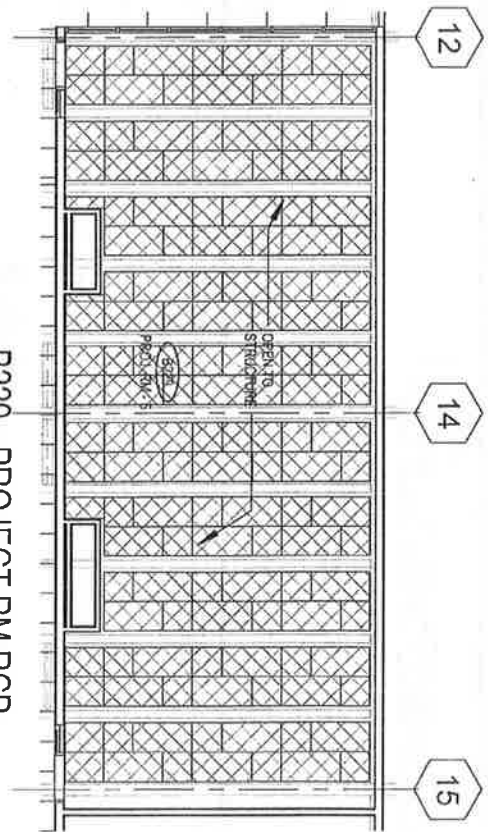

2 B229 - PROJECT RM RCP
1/8" = 1'-0"

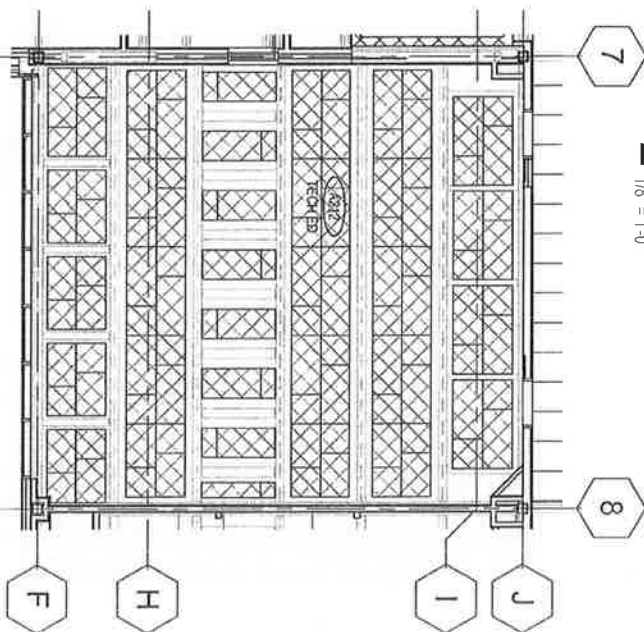

1 A212 - TECH ED RCP
1/8" = 1'-0"

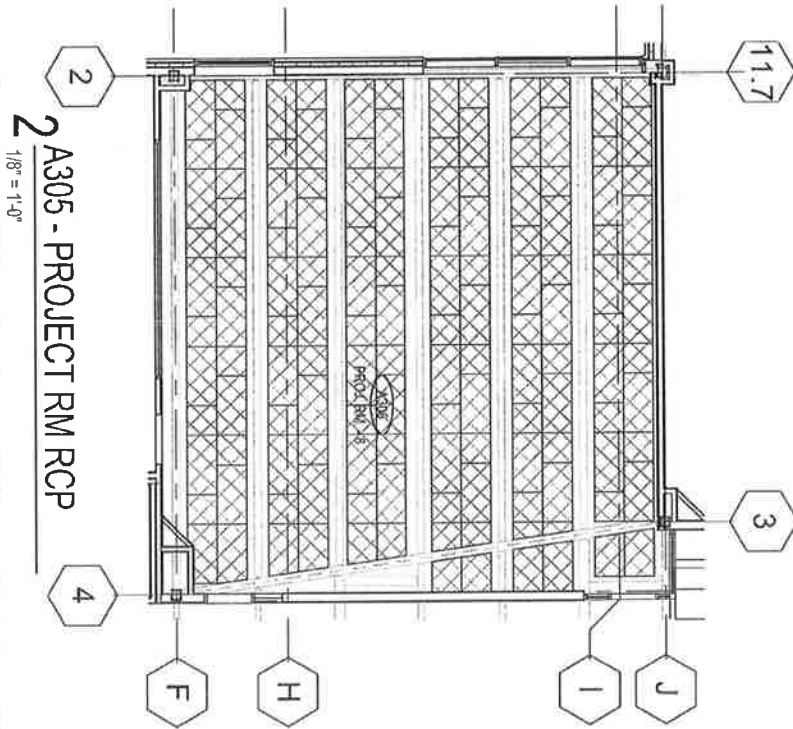

2 A305 - PROJECT RM RCP
1/8" = 1'-0"

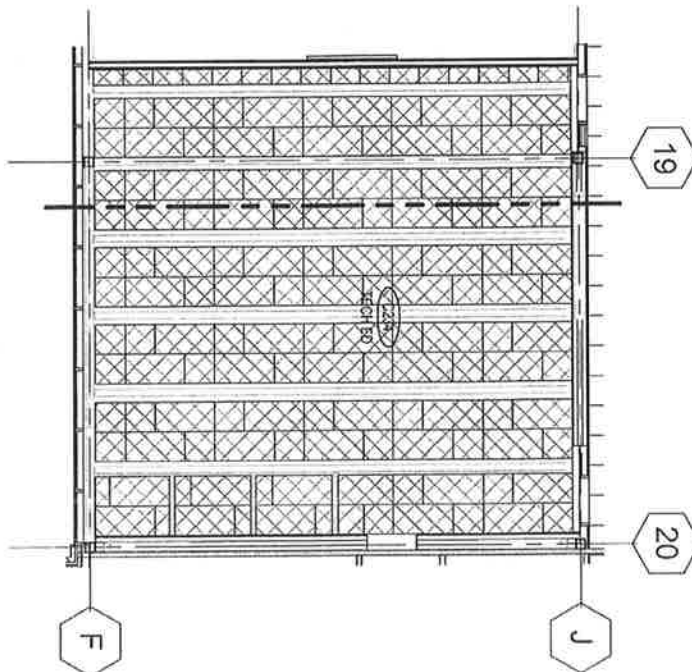

1 C234 - TECH ED RCP
1/8" = 1'-0"

JCJ ARCHITECTURE

25 PROSPECT STREET
HARTFORD, CT 06103
(860) 247-9020

© 2015 JJJ Architecture

CALEB DUSTIN HUNKING SCHOOL

DRAWING REFERENCE: SK-041	
DATE:	XXXXXX
PROJECT:	B13020.01
DRAWN:	CPC
SCALE:	1/8" = 1'-0"

SK-041

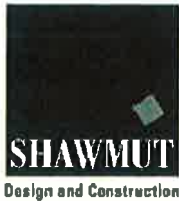

Change Request CR088

To: William Cunniff
Joslin Lesser & Assoc
44 Pleasant Street
Watertown, MA 02472

Date: March 14, 2016
Project #: 131411
Project: MSBA - Haverhill Caleb Dustin MS

Description: Add Full Height Wall Tile in Bathrooms per PR-25

Item Description	Amount
Capital Tile; Add Full Height Wall Tile in Bathrooms per PR-25	\$82,025
Angelini; Area B and C Replace MR Board With Tile Backer. Credit FRP	\$(13,727)
Angelini; Area A Remove Installed MR Board and Replace with Tile Backer. Credit FRP	\$4,189
Fee	\$2,570
GL Insurance	\$570
Builder's Risk	\$135
Bond	\$568
Total:	\$76,330

Type: Lump sum proposal
Schedule Impact: This change will add 0 day(s) to the contract completion date.
Overtime: Project OT Not Required

Notes: Please note this pricing includes removing and replacing MR board already installed in Area A and replacing the MR board with tile backer board at all locations receiving wall tile.

By: William Cunniff, Joslin Lesser & Assoc

Date: 3/16/16

By: Joseph Pollock, Shawmut Design & Construction

Date: 2/14/16

By: Katy Lillich, JCJ Architecture, Inc.

Date: 3-15-16

CONSTRUCTION MANAGER CHANGE ORDER SUMMARY SHEET

PROJECT#: 131411 - Hunking School
CR#: 088
DESCRIPTION: Add Full Height Wall Tile in Bathrooms Per PR-25
DATE: 03/14/16
REFERENCE: PR-25
CONSTRUCTION MANAGER: Shawmut Design and Construction

SECTION I - SUBCONTRACTORS	Direct Costs	Non-Direct Costs	Total Costs
Angelini (Area A)	\$ 4,147.48	\$ 41.52	\$ 4,189
Angelini (Area B and C)	\$ (12,992.38)	\$ (734.62)	\$ (13,727)
Capital Carpet & Flooring	\$ 60,246.54	\$ 21,778.46	\$ 82,025
			\$ -
			\$ -
			\$ -
			\$ -
			\$ -
TOTALS	\$ 51,401.64	\$ 21,085.36	\$ 72,487.00

SECTION II - CM MARK-UPS			Total Costs
Subcontract Direct Costs		\$ 51,401.64	
CM Fee on Direct Costs Only	5.00%	\$ 2,570.00	
Subcontract Non-Direct Costs		\$ 21,085.36	
			\$ 75,057
General Liability Insurance	0.76%	\$ 570.00	
Builder's Risk	0.18%	\$ 135.00	
			\$ 75,762
Payment and Performance Bond	0.75%	\$ 568.00	
TOTAL CHANGE ORDER AMOUNT:		\$	76,330

9-3-13 Version, revised 8.25.2015

SUBCONTRACTOR CHANGE REQUEST

Lower-tier Subs. Use SUB-
SUBCONTRACTOR Form, NOT this
form

Caleb Dustin Hunking School

PROJ. NO.

131411

C.M.

Shawmut Design & Construction

SDC PCI NUMBER:	PR-25
DATE:	3/14/2011

PCI DESC.

Remove installed AIR board and replace with the backer designed and offered for

DATE: 3/14/2016

FIRM SUBMITTING CHANGE REQUEST:

Angelini Plastering Inc.

1. DIRECT LABOR: SUBCONTRACTOR and/or SUB-SUBCONTRACTOR:

Use only: Prevailing Wage Rates or Owner-Approved Wages and Rates
If any work is performed by a lower tier sub, labor rates must be approved by the Owner prior to executing any changes, and those costs presented on a Sub-Subcontractor Change Request Form.

Trade	Classification (Foreman, Journeyman, Apprentice)	Total Hrs. Worked	These values shall be taken from the "Rate Approval Pricing Form" after its approval by the CM and Owner or the Prevailing Wage Table in the specifications.				Total Labor Cost (Wages + Fringe only)
			Hourly Labor Rate (Base + Fringes) (Item 1 from Rate Approval Pricing Form OR Total Rate from PREVAILING WAGE RATE TABLE)	Total Labor Cost (Wages + Fringe only)	Base Wage Rate for Ins/Taxes (Item D from Rate Approval Pricing Form or Base Rate from PREVAILING WAGE RATE TABLE)		
Carpenter	Foreman-MacLean	8.00	\$ 76.86	\$ 614.88	\$ 48.92	\$ 614.88	
Carpenter	Journeyman-API	180.00	\$ 71.86	\$ 12,934.80	\$ 43.92	\$ 12,934.80	
Carpenter	Journeyman-API	(95.00)	\$ 71.86	\$ (6,826.70)	\$ 43.92	\$ (6,826.70)	
Taper	Foreman-Strout		\$ 72.37	\$ -	\$ 44.95	\$ -	
Taper	Journeyman-API		\$ 69.87	\$ -	\$ 42.45	\$ -	
Laborer	Foreman-Delaney	32.00	\$ 57.25	\$ 1,832.00	\$ 35.35	\$ 1,832.00	
			Total Base Wages		\$ (2,649.84)		
TOTAL BASE AND FRINGE DIRECT LABOR COSTS					\$	\$ 8,554.98	

2. MATERIALS: SUBCONTRACTOR:

(For extensive material lists, attach detailed backup and enter as a lump sum below)

Material Description	Qty	Unit	Cost Per Unit	Total
FRP	(5,375.00)	SQFT	\$1.80	\$ (9,675.00)
Tile backer	5,375.00	SQFT	\$0.98	\$ 5,267.50
				\$ -
				\$ -
				\$ -
				\$ -
				\$ -
				\$ -
				\$ -
TOTAL MATERIALS COST:				\$ (4,407.50)

3. EQUIPMENT: SUBCONTRACTOR:

(For extensive equipment lists, attach detailed backup and enter as a lump sum below)

Equipment Description	Qty	Unit	Cost Per Unit	Total
			\$	=
			\$	=
			\$	=
C:\Users\jcloulier\Desktop\MFR-removal to tile backer			\$	=

SDC PCI NUMBER: PR-25
DATE: 3/14/2016

PCI DESC.

Remove installed AIR board and replace with tile backer behind and credit FRP

TOTAL EQUIPMENT COST: \$

-

SDC PCI NUMBER: PR-25
DATE: 3/14/2016

PCI DESC. Remove installed MR board and replace with tile backer dashboard and credit FRP

4. LUMP SUM SERVICES PROVIDED TO SUBCONTRACTOR (Not Typical. Contact GC for Direction):

Description of Lump Sum Service - attach backup	Total
	\$ -
	\$ -
	\$ -
	\$ -
	\$ -
	\$ -
TOTAL LUMP SUM SERVICES COST:	\$ -

5. SUBTOTAL OF SUBCONTRACTOR'S DIRECT COSTS (ITEMS 1, 2, 3, and 4)

\$ 4,147.48

6. SUBCONTRACTOR'S ALLOWED O&P MARK-UP ON ALLOWABLE DIRECT COSTS (10% OF ITEM 5)

10.00%

\$ -

7. INSURANCE AND TAXES ON SUBCONTRACTOR BASE LABOR ONLY:

Total Base Wages Subject to Insurance and Taxes from Item 1 above: \$ (2,649,84)
Insurance & Taxes Rate (30%, or as approved on "RATE APPROVAL PRICING FORM") 30.00%

TOTAL COST INSURANCE AND TAXES ON LABOR

\$ -

8. TOTAL COST OF WORK PERFORMED BY SUBCONTRACTOR (ITEMS 5, 6, and 7): \$ 4,147.48

9. TOTAL COST OF WORK PERFORMED BY SUB-SUBCONTRACTOR(S) (Item 7 on attached Sub-Sub Form): \$ -

10. ** ALLOWABLE MARKUP ON SUB-SUBCONTRACTOR'S WORK (By Contract, 10% of Item 5 on attached Sub-Sub Form) \$ -

11. TOTAL COST OF WORK INCLUDED IN THIS CHANGE REQUEST (ITEMS 9+10): \$ 4,147.48

12. SUBCONTRACTOR BOND

Approved bond premium percentage x item 11:

1.00% x ITEM 11: \$ 41.47

13. TOTAL CHANGE PROPOSAL AMOUNT, including bond cost \$ 4,189.00

Additional Notes:

Change proposals must include a cover letter on company letterhead identifying the PCI number, a description of the scope of work and the total cost of the Change Request.

Contract, the maximum aggregate mark-up allowed on direct allowable costs is 10%, and may be shared between Sub and Sub-Subs, where applicable.

** By

9-3-13 Version, revised 8.25.2015

SUBCONTRACTOR CHANGE REQUESTLower-tier Subs. Use SUB-
SUBCONTRACTOR Form, NOT this
form

Caleb Dustin Hunkin School

PROJ. NO.

131411

C.M. Shawmut Design & Construction

SDC PCI NUMBER: PR-225

DATE: 3/14/2016

PCI DESC.

Replace Mr. board to the backer board at B and C bldg

FIRM SUBMITTING CHANGE REQUEST:

Angelini Plastering Inc

1. DIRECT LABOR: SUBCONTRACTOR and/or SUB-SUBCONTRACTOR:Use only Prevailing Wage Rates or Owner-Approved Wages and Rates
If any work is performed by a lower tier sub, labor rates must be approved by the Owner prior to executing any changes, and those costs presented on a Sub-Subcontractor Change Request Form.

Trade	Classification (Foreman, Journeyman, Apprentice)	Total Hrs. Worked	These values shall be taken from the "Rate Approval Pricing Form", after its approval by the CNL and Owner or the Prevailing Wage Table in the specifications.			Total Labor Cost (Wages + Fringe only)
			Hourly Labor Rate (Base + Fringes) (Item 1 from Rate Approval Pricing Form OR Total Rate from PREVAILING WAGE RATE TABLE)	Total Labor Cost (Wages + Fringe only)	Base Wage Rate for Item 1 from Rate Approval Pricing Form, or Base Rate from PREVAILING WAGE RATE TABLE	
Carpenter	Foreman-MacLean	(2.00)	\$ 76.86	\$ (153.72)	\$ 48.92	\$ (153.72)
Carpenter	Journeyman-API	(150.00)	\$ 71.86	\$ (10,779.00)	\$ 43.92	\$ (10,779.00)
Carpenter	Journeyman-API	\$5.00	\$ 71.86	\$ 6,108.10	\$ 43.92	\$ 6,108.10
Taper	Foreman-Strout		\$ 72.37	\$ -	\$ 44.95	\$ -
Taper	Journeyman-API	(24.00)	\$ 69.87	\$ (1,676.88)	\$ 42.45	\$ (1,676.88)
Laborer	Foreman-DeJuncy	(8.00)	\$ 57.25	\$ (458.00)	\$ 35.35	\$ (458.00)
			Total Base Wages	\$ 2,333.76		
			TOTAL BASE and FRINGE DIRECT LABOR COSTS			\$ (6,959.50)

2. MATERIALS: SUBCONTRACTOR:

(For extensive material lists, attach detailed backup and enter as a lump sum below)

Material Description	Qty	Unit	Cost Per Unit	Total
Mold tough Drywall	(5,292.00)	SQFT	\$0.32	\$ (1,693.44)
FRP	(5,292.00)	SQFT	\$1.80	\$ (9,525.60)
Denshield	5,292.00	SQFT	\$0.98	\$ 5,186.16
				\$ -
				\$ -
				\$ -
TOTAL MATERIALS COST:				\$ (6,032.88)

3. EQUIPMENT: SUBCONTRACTOR:

(For extensive equipment lists, attach detailed backup and enter as a lump sum below)

Equipment Description	Qty	Unit	Cost Per Unit	Total
				\$ -
				\$ -
				\$ -
G:\Caleb Dustin Hunkin\lump Sum Pricing Formats & Log\Subcontractor Change order form 8.25				\$ -

SDC PCI NUMBER:	PR-225
DATE:	3/14/2016

PCI DESC. Replace Air board to the bucket board at B and C bluf

TOTAL EQUIPMENT COST:	\$
	-

SDC PCI NUMBER: **PR 225**
DATE: **3/14/2016**

PCI DESC. **Replace Mr board in the backer board at B and C bldg**

4. LUMP SUM SERVICES PROVIDED TO SUBCONTRACTOR (Not Typical. Contact GC for Direction):

Description of Lump Sum Service - attach backup	Total
	\$ -
	\$ -
	\$ -
	\$ -
	\$ -
TOTAL LUMP SUM SERVICES COST:	\$ -

5. SUBTOTAL OF SUBCONTRACTOR'S DIRECT COSTS (ITEMS 1, 2, 3, and 4)

\$ (12,992.38)

6. SUBCONTRACTOR'S ALLOWED O&P MARK-UP ON ALLOWABLE DIRECT COSTS (10% OF ITEM 5)

\$ (1,299.24)

7. INSURANCE AND TAXES ON SUBCONTRACTOR BASE LABOR ONLY:

Total Base Wages Subject to Insurance and Taxes from Item 1 above	\$ 2,333.76
Insurance & Taxes Rate (30%, or as approved on "RATE APPROVAL PRICING FORM")	30.00%
TOTAL COST INSURANCE AND TAXES ON LABOR	\$ 700.13

8. TOTAL COST OF WORK PERFORMED BY SUBCONTRACTOR (ITEMS 5, 6, and 7):

\$ (13,591.49)

9. TOTAL COST OF WORK PERFORMED BY SUB-SUBCONTRACTOR(S) (Item 7 on attached Sub-Sub Form):

10. ** ALLOWABLE MARKUP ON SUB-SUBCONTRACTOR'S WORK (By Contract, 10% of Item 5 on attached Sub-Sub Form)

11. TOTAL COST OF WORK INCLUDED IN THIS CHANGE REQUEST (ITEMS 9+10):

\$ (13,591.49)

12. SUBCONTRACTOR BOND

Approved bond premium percentage x Item 11.

1.00% x ITEM 11: \$ (135.91)

13. TOTAL CHANGE PROPOSAL AMOUNT, including bond cost

\$ (13,727.00)

Additional Notes:

Change proposals must include a cover letter on company letterhead identifying the PCI number, a description of the scope of work and the total cost of the Change Request.

Contract, the maximum aggregate mark-up allowed on direct allowable costs is 10%, and may be shared between Sub and Sub-Subs, where applicable.

** By

Lower-tier Subs, Use SUB-
SUBCONTRACTOR Form, NOT this form

C.M.
Shawmut Design & Construction
440, A105A, A105B

CAPITAL CARPET AND FLOORING, SPEC. INC.

Use only Prevailing Wage Rates or Owner-Approved Wages and Rates. Any work is performed by a lower tier sub, labor rates must be approved by the Owner prior to executing any changes, and these costs presented on a Sub-Subcontractor Change Request Form.

Trade	Classification (Foreman, Journeyman, Apprentice)	Total Hrs. Worked	These values shall be taken from the "REQUEST FOR APPROVAL FOR CHANGE ORDER PRICING" form, after its approval by the CM and Owner				Total Direct Labor Cost
			Total Hourly Labor Costs (Item I from Wage Approval Sheet)	Total Base Cost + Fringe	Wages	Base Wage Rate for Ins/Taxes (Item D from Wage Approval Sheet)	
PIPE MECHANIC	FOREMAN	630.00	\$ 82.05	\$ 52,512.00	\$ 49.96	\$ 52,512.00	
			\$ -	-		\$ -	
			\$ -	-		\$ -	
			\$ -	-		\$ -	
			\$ -	-		\$ -	
			Total Base Wages	\$ 52,512.00			
TOTAL BASE AND FRINGE DIRECT LABOR COSTS						\$ 52,512.00	

For extensive material lists attach detailed backup and enter as a lump sum below.)

Material Description	Qty	Unit	Cost Per Unit	Total
CTW - 3 - T-3 3'X6' 0190 ARCTIC WHITE WALL TILE	4,112.50	SF	\$1.36	\$ 5,593.00
CTW - 3 - T-3 3'X6' 0190 ARCTIC WHITE BULLMOSE TILE 3' SIDE	748.00	EA	\$0.61	456.28
CTW - 3 - T-3 3'X6' 0190 ARCTIC WHITE BULLMOSE TILE 6' SIDE	24.00	EA	\$0.61	14.64
LATICRETE 255 WHITE	46.00	EA	\$30.75	1,413.58
LATICRETE 1600 GROUT 8# UNITS	27.00	EA	9.52	257.04
				\$
				\$
TOTAL MATERIALS COST:			\$	7,734.54

(For extensive equipment lists, attach detailed backup and enter as a lump sum below)

Equipment Description	Qty	Unit	Cost Per Unit	Total
				\$
				\$
				\$
				\$
				\$
TOTAL EQUIPMENT COST:				\$

3/11/2016
C:\OR 25

SL PLT WITHSTAIL WAIL THE IN: C136A, C136B, H124A, H124B, A100A, A100B

CAPITAL CARPET AND FLOORING SPEC. INC.

LUMP SUM SERVICES PROVIDED TO SUBCONTRACTOR (Not Typical, Contact GC for Direction):

Description of Lamp Store Service - attach backup	Total
S	-
S	-
S	-
S	-
S	-
S	-
TOTAL OF ALL LAMP STORES	0

5. (11) 246 72

10.00%	5	6.02465
--------	---	---------

5	52.512 (H)
	30.00%

1875360

82.024.79

TOTAL COST OF WORK PERFORMED BY SI B-SUB CONTRACTOR(S) (Item 7 on attached Sub-Sub Form):

4. ALLOWABLE MARKUP ON SUBCONTRACTOR'S WORK (By Contract, 10% of Item 5 on attached Sub-Sub Form,

TOTAL COST OF WORK INCLUDED IN THIS CHANGE REQUEST (ITEMS 9+10):	\$ 82,024.7
--	-------------

1

TOTAL CHANGE PROPOSAL AMOUNT, including bond cost	\$ 82,025.00
---	--------------

Additional Notes:

Change proposals must include a cover letter on company letterhead identifying the PCI number, a description of the scope of work and the total cost of the Change Request.

²² By contract, the maximum aggregate mark-up allowed on direct allowable costs is 10%, and may be shared between Sub and Sub-Subs, where applicable.

AIA® Document G709™ – 2001

Work Changes Proposal Request

PROJECT *(Name and address):*

Caleb Dustin Hunking School
98 Winchester Street
Haverhill, MA 01835

PROPOSAL REQUEST NUMBER: 025

DATE OF ISSUANCE: 03/04/2016

OWNER: ☐

ARCHITECT: ☐

CONSULTANT: ☐

CONTRACTOR: ☐

FIELD: ☐

OTHER: ☐

OWNER *(Name and address):*

City of Haverhill
Four Summer Street, Room 100
Haverhill, MA 01830

CONTRACT FOR: General Construction

CONTRACT DATE: May 14, 2013

FROM ARCHITECT *(Name and address):*

JCJ Architecture
One State Street, Suite 900
Boston, MA 02109

ARCHITECT'S PROJECT NUMBER:
B130200.00

TO CONTRACTOR *(Name and address):*

Shawmut Design & Construction
560 Harrison Avenue
Boston, MA 02118

Please submit an itemized proposal for changes in the Contract Sum and Contract Time for proposed modifications to the Contract Documents described herein. Within Zero (0) days, the Contractor must submit this proposal or notify the Architect, in writing, of the date on which proposal submission is anticipated.

THIS IS NOT A CHANGE ORDER, A CONSTRUCTION CHANGE DIRECTIVE OR A DIRECTION TO PROCEED WITH THE WORK DESCRIBED IN THE PROPOSED MODIFICATIONS.

DESCRIPTION *(Insert a written description of the Work):*

Provide pricing for replacing FRP with tile in bathrooms C136A, C136B, B124A, B124B, A108A and A108B as shown on attached drawings.

ATTACHMENTS *(List attached documents that support description):*

A-410-R2, A-411-R2 & A-412-R2

REQUESTED BY THE ARCHITECT:

(Signature)

Katy Lillich
(Printed name and title)

